

Film-Tech

The information contained in this Adobe Acrobat pdf file is provided at your own risk and good judgment.

These manuals are designed to facilitate the exchange of information related to cinema projection and film handling, with no warranties nor obligations from the authors, for qualified field service engineers.

If you are not a qualified technician, please make no adjustments to anything you may read about in these Adobe manual downloads.

www.film-tech.com

Plug-in 70mm PHC & MIC Control Plate Assembly Parts List

PRODUCT INFORMATION BULLETIN #3857

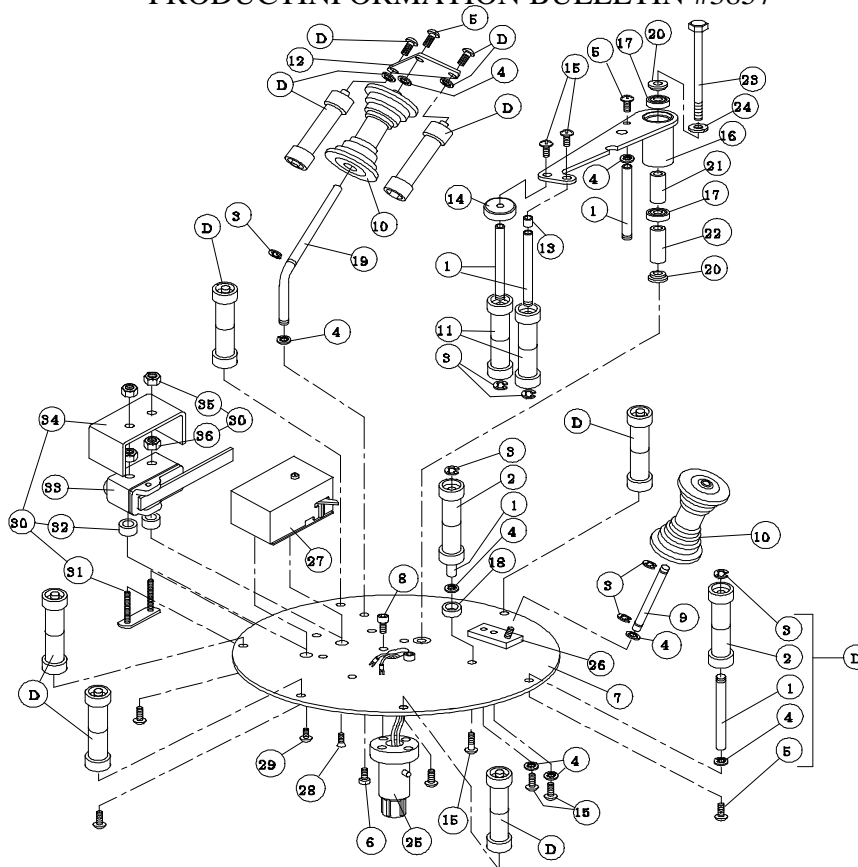

- | | |
|---|---|
| 3046 Control Plate Assy., Plug-In, 70mm MIC Complete | 20) 2380 Control Plate Sensor Arm Washer |
| 3071 Control Plate Assy., Plug-In, 70mm PHC Complete | 21) 2379 Control Plate Sensor Arm Spacer |
| D) 2876 Spool & Shaft Assy., 70mm (includes 1-5) | 22) 1742 Control Plate Arm Hub Standoff, 70mm |
| 1) 1431 Spool Shaft, 70mm | 23) 3009 HHCS, 1/4-28 x 3 3/4" |
| 2) 1491 Spool Assembly, 70mm | 24) 1079 Lockwasher, 1/4" Split Ring |
| 3) 1050 E-Ring, 5/16" | 25) 3443 Control Plate, Plug-In Adapter 70mm (Includes item 8) |
| 4) 1078 Lockwasher, #10, Internal Tooth | 26) 4323 Control Plate Angle Block 70mm
PHC Control Plate Only |
| 5) 1071 Screw PTH, 10-32 x 3/8" | 27) 2430 Phase Control Assy., w/mounting package (Includes 28 & 29) |
| 6) 1592 SHCS, 10-32 x 1/2" | 28) 1070 Screw, PFH, 8-32 x 3/8" |
| 7) 2210 Control Plate & Nut Sub Assy. 70mm | 29) 1069 Screw, PTH, 8-32 x 3/8" |
| 8) 1064 SHCS, 8-32 x 3/8" | MIC Control Plate Only |
| 9) 1654 Pulley Shaft-Castor, 5/16" Dia. 70mm | 30) 3610 Control Plate Micro Switch Mount Hardware (Includes 31, 32, 34, 35 & 36) |
| 10) 1715 Pulley Assy. 5/16" ID, 70mm | 31) 1469 Switch Adjusting Plate Assy. |
| 11) 3067 Sensor Arm Spool Assy. 70mm | 32) 1240 Spacer, 5/16" x 13/64" x 1/4" |
| 12) 1436 Control Plate Keeper Tab, 70mm | 33) 2536 Micro Switch-Flat Blade-HD |
| 13) 1153 Control Plate Arm Spool Spacer Float | 34) 1595 Micro Switch Cover |
| 14) 2006 Control Plate Arm Film Spacer | 35) 1084 Locknut, Nylon Insert, 6-32 |
| 15) 1072 Screw, PTH, 10-32 x 1/2" | 36) 1083 Hex Nut, 6-32 |
| 16) 1691 Control Plate Sensor Arm & Hub | |
| 17) 2407 Bearing, 5/8 OD x 1/4 ID | |
| 18) 4301 Control Plate Feed Exit Spool Spacer, 70mm | |
| 19) 1658 Control Plate Exit Shaft #3, 5/16" Dia. 70mm | |