

Film-Tech

The information contained in this Adobe Acrobat pdf file is provided at your own risk and good judgment.

These manuals are designed to facilitate the exchange of information related to cinema projection and film handling, with no warranties nor obligations from the authors, for qualified field service engineers.

If you are not a qualified technician, please make no adjustments to anything you may read about in these Adobe manual downloads.

www.film-tech.com

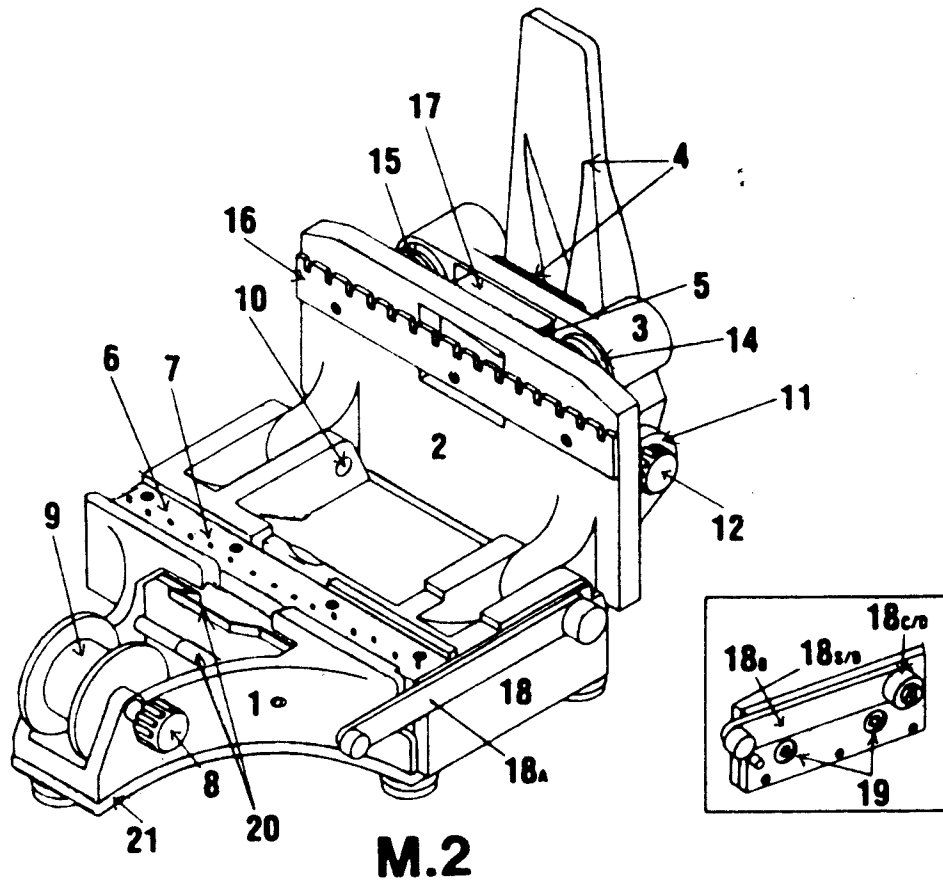

J & R Film and Video Co.
 Ciro Equipment Company
 1135 North Mansfield Ave.
 Hollywood, Calif. 90038

Phone: 1-877-MOVIOLA
 (323) 467-3107
 Fax: (323) 466-2201

WEBSITE: <http://www.moviola.com>

CIRO REPLACEMENT PARTS

PART NO.	DESCRIPTION	S-8mm Plastic	S-8mm Metal	S-8mm Pro	S-8mm 1:3&1:4	16mm M2	16mm M3	16mm DP	16mm FR	26mm DR	35mm M2	35mm M3	35mm CS	35mm NP	35mm 8P	35mm DR	70mm 4T	3/4 Video
1	BASE CASTING	9.26	12.57	116.90	116.90	116.90	116.90	116.90	116.90	116.90	116.90	116.90	116.90	116.90	116.90	135.36	135.36	135.36
2	TOP CASTING	—	—	104.86	104.86	104.86	104.86	104.86	104.86	104.86	104.86	104.86	104.86	104.86	104.86	123.05	123.05	123.05
3	HOLDER CASTING	6.15	6.96	70.62	70.62	70.62	70.62	70.62	70.62	70.62	70.62	70.62	70.62	70.62	70.62	108.07	108.07	108.07
4	LEVER & PLATE	—	—	49.22	49.22	49.22	49.22	49.22	49.22	49.22	49.22	49.22	49.22	49.22	49.22	58.85	58.85	58.85
5	PERFORATOR	27.29	27.29	163.71	163.71	96.57	96.57	179.76	192.60	—	112.35	112.35	203.30	203.30	214.00	—	203.30	—
6	MATRIX	24.61	34.78	180.03	180.03	87.74	87.74	179.76	179.76	276.86	87.74	87.74	219.35	87.74	103.79	224.70	191.53	—
7	REGISTRATION PINS	—	—	7.56	7.56	7.56	7.56	7.56	7.56	—	7.56	7.56	7.56	7.56	7.56	—	7.56	—
8	TAPE ROLLER SHAFT	—	5.89	5.89	5.89	5.89	7.38	7.38	7.38	15.46	8.03	15.46	15.46	15.46	15.46	15.46	15.46	15.46
9	TAPE ROLLER	6.15	4.82	4.61	4.61	4.61	9.91	4.61	4.61	4.61	4.61	9.91	4.61	4.61	4.61	4.61	4.61	4.61
9A	REGULATION KNOB	—	—	—	—	—	12.19	—	—	—	—	12.19	—	—	—	—	—	—
10	HINGE PINS (2)	—	—	17.54	17.54	17.54	17.54	17.54	17.54	17.54	17.54	17.54	17.54	17.54	17.54	17.54	17.54	17.54
11	LEVER PIVOT PIN	—	—	11.70	21.33	21.33	21.33	11.70	11.70	11.70	11.70	11.70	11.70	11.70	11.70	11.70	11.70	11.70
12	KNURLED NUTS	—	—	3.02	3.02	3.02	3.02	3.02	3.02	3.02	3.02	3.02	3.02	3.02	3.02	3.02	3.02	3.02
14	GUIDE POSTS (2)	—	—	52.91	52.91	52.91	52.91	52.91	65.22	65.22	65.22	65.22	65.22	65.22	65.22	65.22	65.22	65.22
15	COMPRESSION SPRINGS	—	—	8.30	8.30	8.30	8.30	8.30	8.30	8.30	8.30	8.30	8.30	8.30	8.30	8.30	8.30	8.30
16	HOLD DOWN PLATE	5.35	5.89	33.22	33.22	11.70	20.67	33.22	33.22	—	—	—	—	—	—	—	—	—
17	'U' BLADE	9.26	9.26	48.00	48.00	48.00	48.00	48.00	90.14	49.20	49.20	49.20	49.20	49.20	81.20	110.00	120.00	120.00
17A	TAPE PRESSURE PIECE	—	—	—	—	—	12.00	—	—	—	—	12.50	—	—	—	—	—	—
18	SIDE CUTTER ASSEMBLY	13.50	13.50	75.00	75.00	75.00	75.00	105.00	105.00	105.00	105.00	105.00	105.00	105.00	105.00	152.00	152.00	152.00
18L	STRT. CUTTER w/LIGHT	—	—	—	—	—	—	—	—	266.00	266.00	266.00	266.00	266.00	266.00	—	—	—
18A	LONG CUTTER KNIFE	—	—	45.60	45.60	45.60	45.60	45.60	57.00	57.00	57.00	57.00	57.00	57.00	57.00	98.00	98.00	—
18B	SHORT CUTTER KNIFE	—	—	40.00	40.00	40.00	40.00	40.00	48.30	48.30	48.30	48.30	48.30	48.30	48.30	80.60	80.60	80.60
18C	SPRING COVER	—	—	4.25	4.25	4.25	4.25	4.25	4.25	4.25	4.25	4.25	4.25	4.25	4.25	4.25	4.25	4.25
18D	KNIFE SPRING	—	—	4.25	4.25	4.25	4.25	4.25	4.25	4.25	4.25	4.25	4.25	4.25	4.25	4.25	4.25	4.25
18E	DISTANCE TUBE	—	—	4.25	4.25	4.25	4.25	4.25	4.25	4.25	4.25	4.25	4.25	4.25	4.25	4.25	4.25	4.25
18S/D	STRT. & DIAG. CUTTER	—	—	177.00	177.00	177.00	177.00	177.00	177.00	177.00	177.00	177.00	177.00	177.00	177.00	—	—	—
18S/DL	STRT. & DIAG. w/LIGHT	—	—	—	—	—	—	—	—	270.00	270.00	270.00	270.00	270.00	270.00	—	—	—
19A	SPACER FLAT SPRING	—	—	18.00	18.00	18.00	18.00	18.00	18.00	18.00	18.00	18.00	18.00	18.00	18.00	18.00	18.00	18.00
20	NEW BRIDGE	—	—	73.00	73.00	73.00	73.00	73.00	73.00	73.00	73.00	73.00	73.00	73.00	73.00	73.00	73.00	73.00
20A	MOVABLE BAR	—	—	—	—	—	20.00	—	—	—	—	20.00	—	—	—	—	—	—
20B	BAR SCREWS (2)	—	—	—	—	—	2.60	—	—	—	—	2.60	—	—	—	—	—	—
20C	BAR SPRINGS (2)	—	—	—	—	—	2.60	—	—	—	—	2.60	—	—	—	—	—	—
20D	MOVEMENT PINS (2)	—	—	—	—	—	2.60	—	—	—	—	2.60	—	—	—	—	—	—
21	SKID PLATE	—	—	68.00	—	68.00	68.00	68.00	68.00	68.00	68.00	68.00	68.00	68.00	68.00	68.00	68.00	68.00
22	REGULATION KNOB	—	—	—	—	—	15.50	—	—	—	—	36.00	—	—	—	—	—	—
22A	REGULATION SHAFT	—	—	—	—	—	7.00	—	—	—	—	7.00	—	—	—	—	—	—
22B	BRASS SLIDER	—	—	—	—	—	24.00	—	—	—	—	54.00	—	—	—	—	—	—
22C	REGULATION SPRING	—	—	—	—	—	2.50	—	—	—	—	2.50	—	—	—	—	—	—
22D	SLIDER SPRING	—	—	—	—	—	2.50	—	—	—	—	2.50	—	—	—	—	—	—
22E	SLIDER PINS (2)	—	—	—	—	—	7.60	—	—	—	—	7.60	—	—	—	—	—	—
23	PIN SHAFT	—	—	—	—	—	18.00	—	—	—	—	54.00	—	—	—	—	—	—
23A	ALTERNATE PINS (2)	—	—	—	—	—	2.60	—	—	—	—	3.75	—	—	—	—	—	—
23B	ALTERNATE SPRING	—	—	—	—	—	15.75	—	—	—	—	15.75	—	—	—	—	—	—
24	2 ROLL TAPE HOLDER	—	—	77.00	77.00	77.00	77.00	77.00	77.00	77.00	85.00	85.00	85.00	85.00	85.00	—	—	—
25	FILM CLIPS	—	—	—	—	—	6.00	—	—	—	—	—	—	—	—	—	—	—
25A	TAPE GUIDE PLATE	—	—	—	—	—	10.00	—	—	—	—	—	—	—	—	—	—	—
25B	TAPE GUIDE SCREWS	—	—	—	—	—	2.50	—	—	—	—	—	—	—	—	—	—	—
26	2" TAPE HOLDER	—	—	—	—	—	—	—	—	115.00	—	—	—	—	—	—	—	—
27	PRESSURE PIECE	—	—	—	—	9.50	—	—	—	—	9.50	—	—	—	—	—	—	—

When Ordering Parts Please Specify Part number and Spicer (i.e. 1 lever for a 16mm 2T should be ordered as follows: 1 #4-16mm 2T. LEVER) and indicate M2 or M3 model.

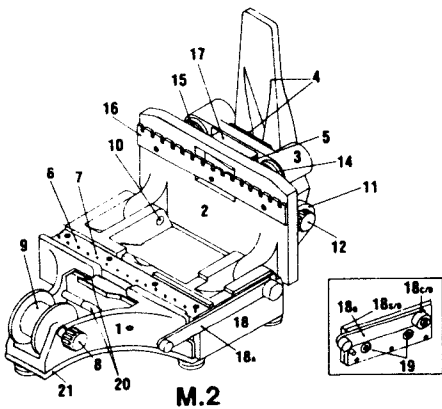

CIRO EQUIPMENT CORPORATION

6820 Romaine St.,
Hollywood, CA, 90038
213-467-3107

TWX: 910-321-4220 JR FILM
FAX: 213-466-2201

