

Film-Tech

The information contained in this Adobe Acrobat pdf file is provided at your own risk and good judgment.

These manuals are designed to facilitate the exchange of information related to cinema projection and film handling, with no warranties nor obligations from the authors, for qualified field service engineers.

If you are not a qualified technician, please make no adjustments to anything you may read about in these Adobe manual downloads.

www.film-tech.com

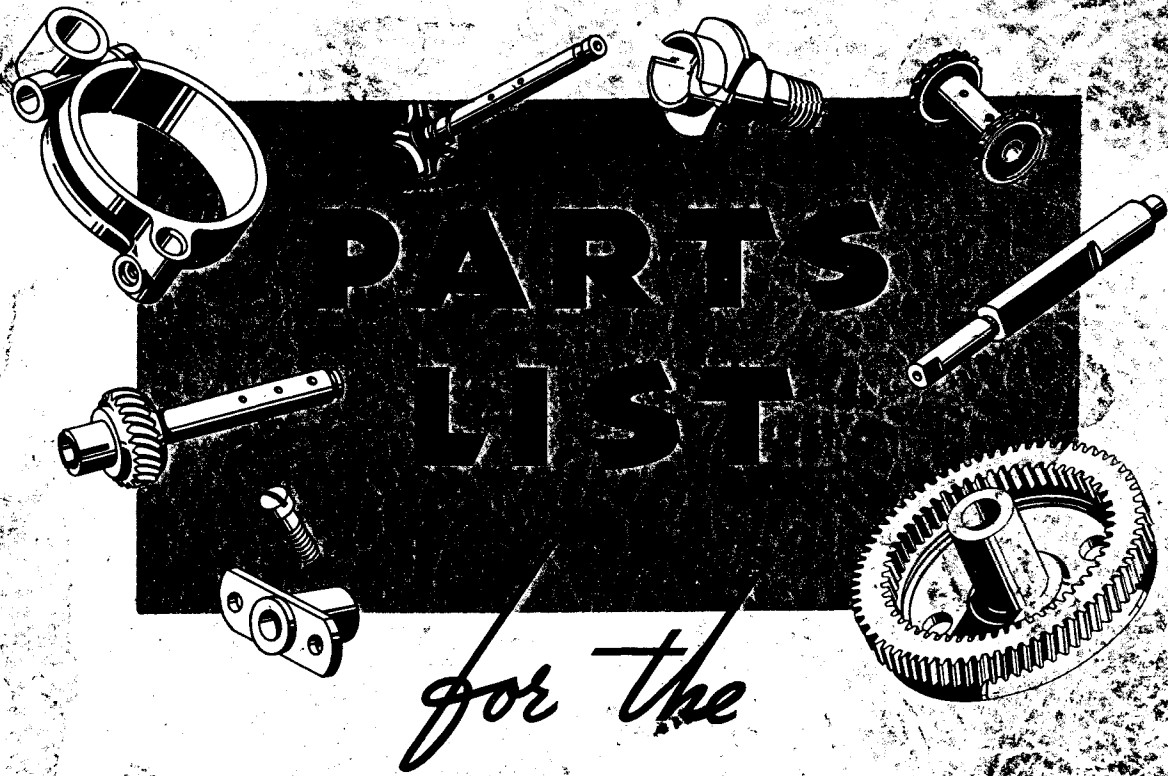

Simplex

REGULAR

Simplex Front & Rear Shafts

NATIONAL THEATRE SUPPLY

Copyright 1945
by
NATIONAL-SIMPLEX-BLUDWORTH, INC.

ORDER PARTS FROM:

EDWARD H. WOLK, INC

921 SOUTH JEFFERSON ST.

CHICAGO, ILL. 60607-4422

1-800-621-4424

(312) 939-2720

FAX: 312-939-0654

www.edwolk.com

Make Parts-Ordering **AS SIMPLE AS A-B-C!**

•

IN PLANNING this book we had only *one* objective—to enable you to place your order for replacement parts quickly and accurately, avoiding the costly, time-consuming errors which often result in interrupted performance and lost revenue.

That is why we have spared no time, effort and expense in making this a book which will literally place the information you want right at your fingertips.

We have given particular attention to the illustrations and have used the modern art technique known as the “exploded view” in which each part may be clearly seen in relation to its associated units in each assembly.

We believe you will find that with this book as a guide, ordering Simplex parts becomes as simple as A-B-C—

A—*Locate the part you want on the illustration.*

B—*Jot down the part number.*

C—*Place your order with your nearest NATIONAL branch.*

USE ONLY **GENUINE** *Simplex* PARTS

*Safeguard your
most Valuable Assets*

GOOD PROJECTION • PLEASSED PATRONS
with Genuine
S I M P L E X P A R T S

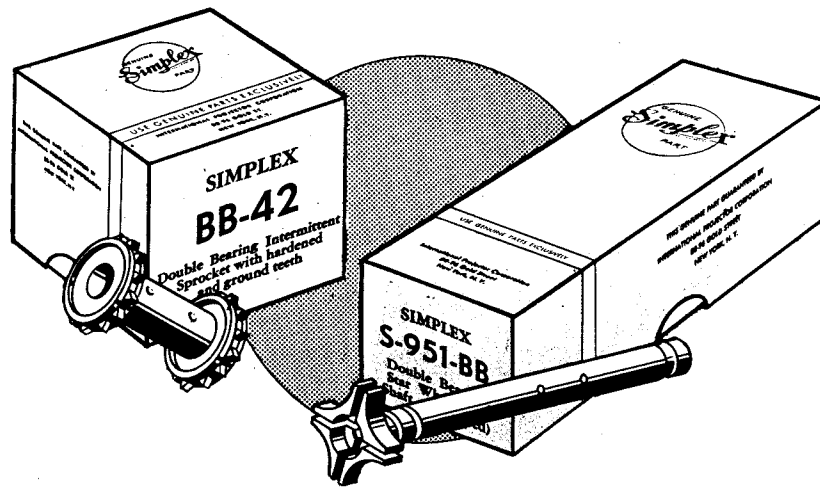

Join the ranks of SIMPLEX Owners for they are the ones that lead all others in loyalty to the Projectors and Parts they are using today. Men who have seen them at work for well over three decades—men who have put their trust in them and found their confidence justified—they are the men that proudly tell others about the extraordinary performance and rugged dependability of Simplex Projectors and Simplex Parts.

And when replacement parts are necessary, demand and use only Genuine Simplex Parts—packed in the distinctive yellow and black box—your guarantee of Better Projection.

BETTER PROJECTION PAYS

TABLE OF CONTENTS

Automatic Fire Shutter Device.....	18-19
Doors and Covers.....	46-47
Double Shutter Attachment.....	50-52
Film Trap.....	14-15
Film Trap Asbestos Heat Shield.....	11
Film Trap Door.....	12-13
Film Trap Door Holder and Lock.....	16-17
Focusing Device.....	48-49
Framing Device.....	39
Intermediate Gear and Associated Parts.....	24-27
Intermittent Movement.....	8-10
Lens Holder.....	48-49
Lower Sprocket and Associated Parts.....	30-31
Main Drive Shaft and Gear.....	18-19
Main Frame - Film Side.....	42-43
Main Frame - Gear Side.....	44-45
Rear Shutter and Associated Parts.....	32-38
Shutter Adjusting Device.....	39
Shutter Gear Bracket.....	20-23
Upper Sprocket and Associated Parts.....	28-29
Vertical Shaft and Associated Parts.....	40-41
Price List.....	55-58

S-7
E
S-724

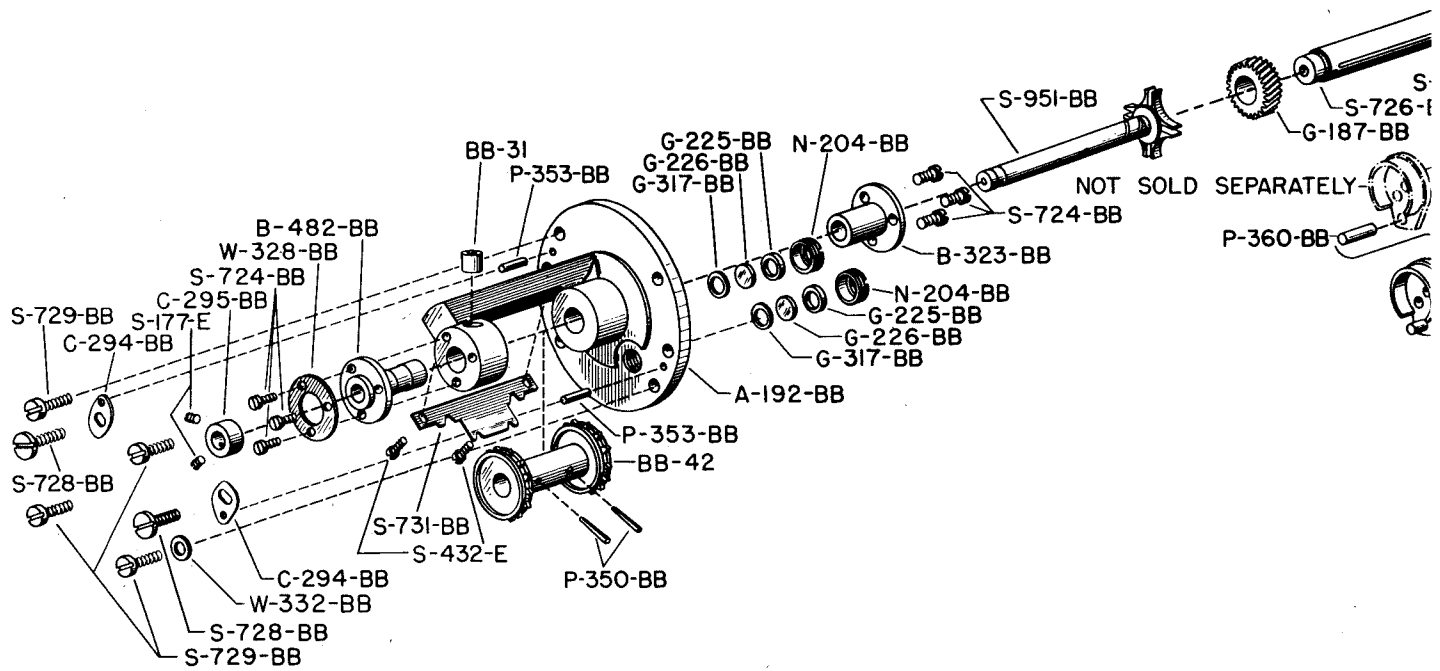

INTERMITTENT MOVEMENT

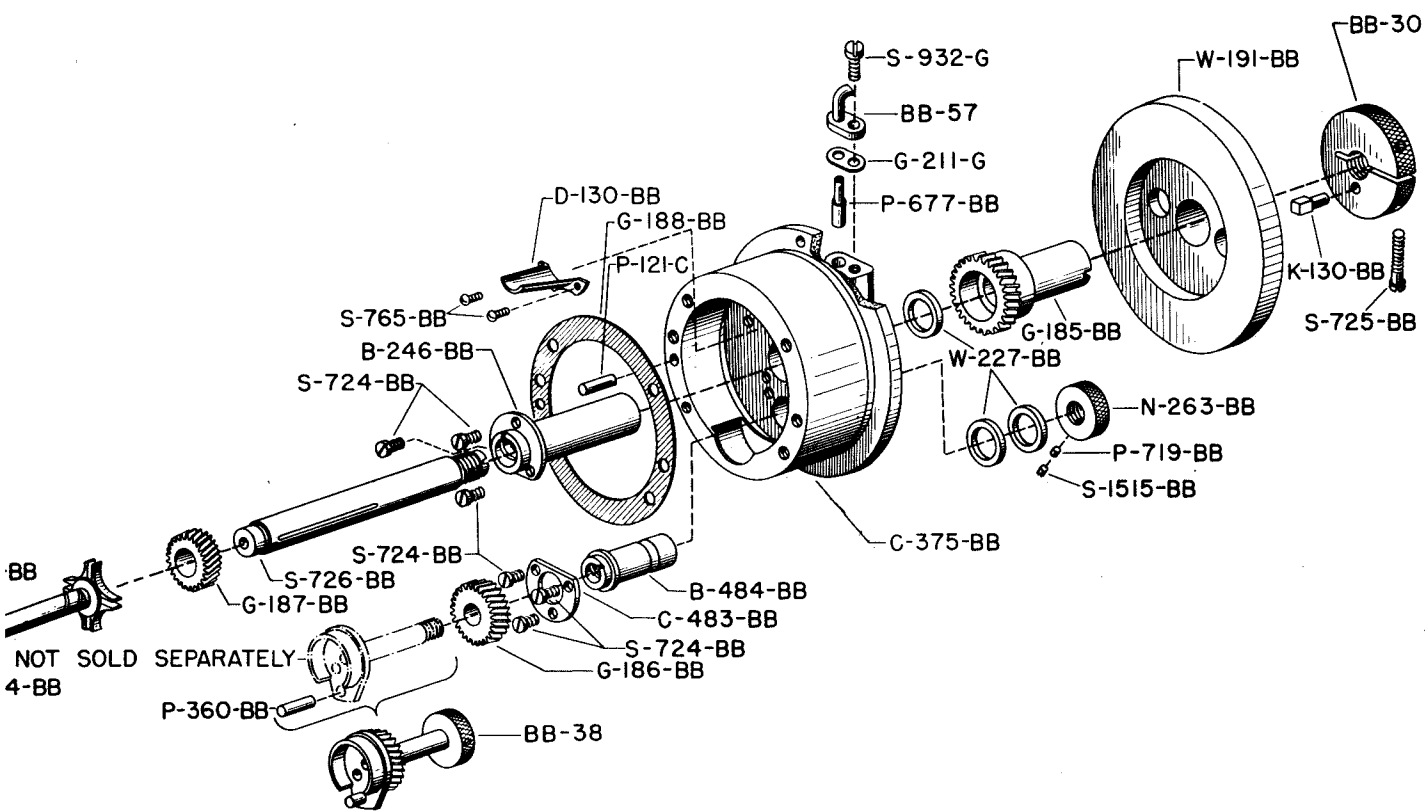

INTERMITTENT MOVEMENT

INTERMITTENT MOVEMENT

BB-54 INTERMITTENT MOVEMENT COMPLETE

ASSEMBLIES

- BB-27 FLYWHEEL GEAR AND SHAFT ASSEMBLY
G-187-BB S-726-BB
- BB-28 FLYWHEEL AND GEAR ASSEMBLY
G-185-BB W-191-BB
- BB-30 FLYWHEEL LOCKNUT AND KEY ASSEMBLY
K-130-BB S-725-BB
- BB-38 INTERMITTENT CAM ASSEMBLY
BB-56 G-186-BB P-360-BB
- BB-40 INTERMITTENT CASE COVER AND ARM ASSEMBLY
A-192-BB G-226-BB (2) N-204-BB (2)
BB-31 G-317-BB (2) P-353-BB (2)
G-225-BB (2)
- BB-52 INTERMITTENT CASE COVER AND BEARING ASSEMBLY
A-192-BB G-225-BB (2) S-177-E
B-323-BB G-226-BB (2) S-432-E (2)
B-482-BB G-317-BB (2) S-724-BB (6)
BB-31 N-204-BB (2) S-731-BB
C-295-BB P-353-BB (2) W-328-BB
- BB-56 CAM SHAFT ADJUSTING NUT ASSEMBLY (INCLUDED IN BB-38)
N-263-BB P-719-BB S-1515-BB
- BB-58 INTERMITTENT CASE AND OIL TUBE ASSEMBLY
BB-57 G-211-G P-677-BB
C-375-BB P-121-C S-932-G

PARTS

- A-192-BB Intermittent Case Cover and Arm
B-246-BB Flywheel Shaft Bearing
B-323-BB Starwheel Shaft Bearing (Inner)
B-482-BB Starwheel Shaft Bearing (Outer)
B-484-BB Cam Shaft Bearing
BB-31 Bearing Oil Cup (Outer)
BB-42 Intermittent Sprocket (Includes two P-350-BB Pins)
BB-57 Intermittent Oil Tube and Flange
C-294-BB Intermittent Case Cover Clamp (2)
C-295-BB Starwheel Shaft Collar
BB-47 ~~INTERMITTENT SPROCKET~~ USE LAVEZZI # 416 TL31B

INTERMITTENT MOVEMENT (continued)

C-375-BB	Intermittent Case
C-483-BB	Cam Shaft Bearing Collar
D-130-BB	Oil Deflector
G-185-BB	Flywheel Gear
G-186-BB	Intermittent Cam Gear
G-187-BB	Flywheel Shaft Gear
G-188-BB	Intermittent Case Cover Oil Gasket
G-211-G	Intermittent Oil Tube Gasket
G-225-BB	Oil Sight Glass Gasket (Inner) (2)
G-226-BB	Oil Sight Glass (2)
G-317-BB	Oil Sight Glass Gasket (Outer) (2)
K-130-BB	Flywheel Lock Key
N-204-BB	Oil Sight Glass Nut (2)
N-263-BB	Cam Shaft Adjusting Nut
P-121-C	Intermittent Case Cover and Arm Pivot Pin
P-350-BB	Intermittent Sprocket Pin (2)
P-353-BB	Intermittent Case Retaining Clamp Pivot Pin (2)
P-360-BB	Intermittent Cam Pin
P-677-BB	Intermittent Case Oil Regulating Plug
P-719-BB	Cam Shaft Adjusting Plug
S-177-E	Starwheel Shaft Collar Set Screw (2)
S-432-E	Intermittent Sprocket Stripper Fastening Screw (2)
S-724-BB	Bearing Fastening Screw (12)
S-725-BB	Flywheel Lock Screw
S-726-BB	Flywheel Shaft
S-728-BB	Intermittent Case Retaining Clamp Screw (2)
S-729-BB	Intermittent Case Cover Screw (4)
S-731-BB	Intermittent Sprocket Stripper
S-765-BB	Oil Deflector Fastening Screw (2)
S-932-G	Intermittent Oil Tube Flange Fastening Screw
S-951-BB	Starwheel and Shaft
S-1515-BB	Cam Shaft Adjusting Nut Set Screw
W-191-BB	Flywheel
W-227-BB	Oil Retaining Washer (For B-246-BB and B-484-BB) (3)
W-328-BB	Starwheel Shaft Outer Bearing Washer
W-332-BB	Oil Drain Screw Washer

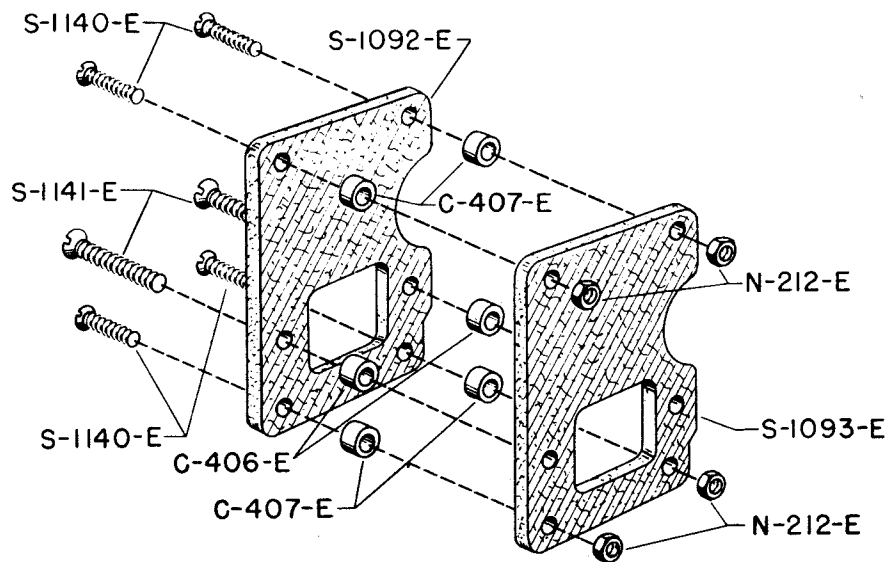

FILM TRAP ASBESTOS HEAT SHIELD

ASSEMBLIES

E-40 FILM TRAP ASBESTOS HEAT SHIELD ASSEMBLY

C-406-E	Heat Shield Fastening Screw Spacer Washer (2)
C-407-E	Heat Shield Spacer Collar (4)
N-212-E	Heat Shield Spacer Screw Nut (4)
S-1092-E	Heat Shield (Rear)
S-1093-E	Heat Shield (Front)
S-1140-E	Heat Shield Spacer Screw (4)
S-1141-E	Heat Shield Fastening Screw (2)

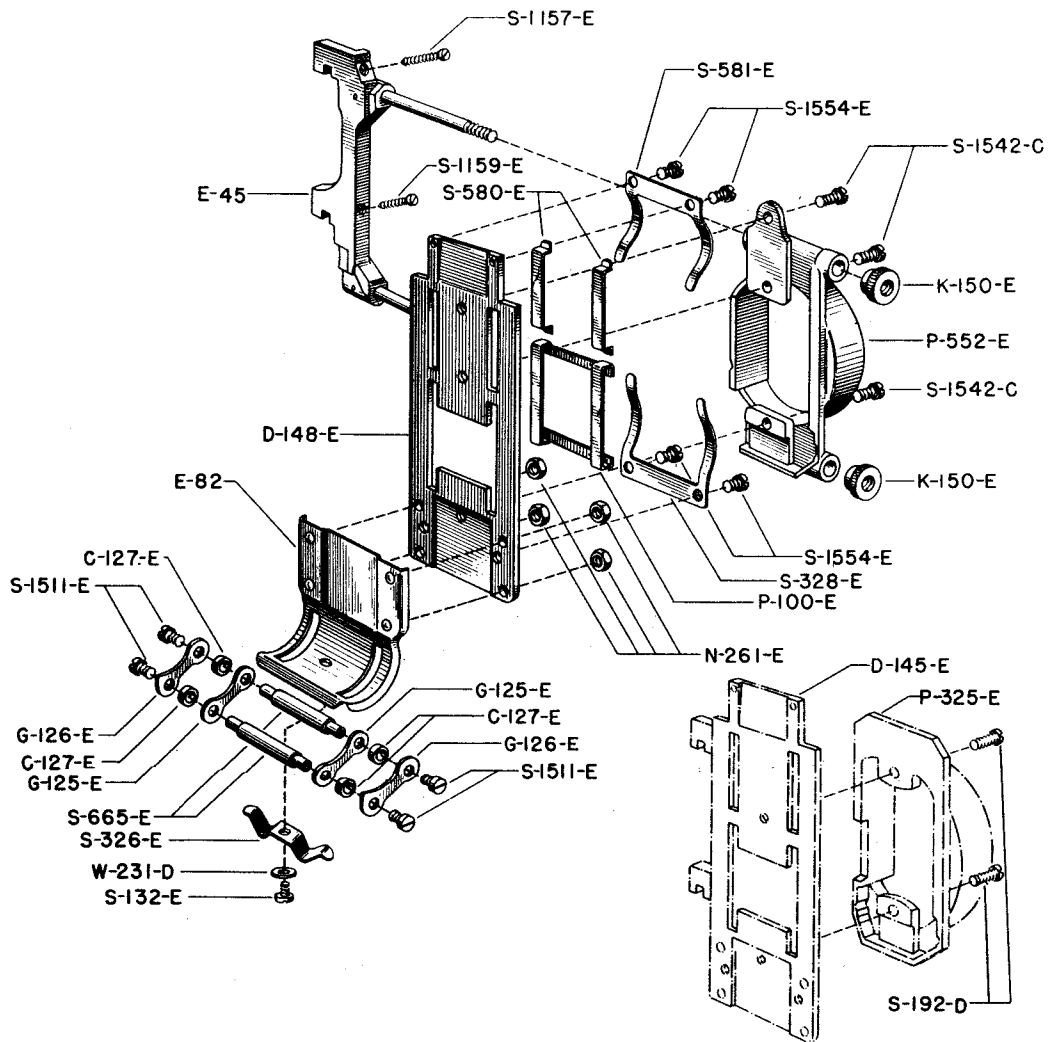

FILM TRAP DOOR

FILM TRAP DOOR

E-46 REMOVABLE FILM TRAP DOOR AND BRACKET COMPLETE

ASSEMBLIES

E-3 INTERMITTENT FILM GUIDE ASSEMBLY (INCLUDED IN E-49)
C-127-E (4) G-126-E (2) S-1511-E (4)
G-125-E (2) S-665-E (2)

E-45 REMOVABLE FILM TRAP DOOR LOCATING BRACKET ASSEMBLY
K-150-E (2) S-1157-E S-1159-E

E-49 REMOVABLE FILM TRAP DOOR ASSEMBLY
D-148-E P-552-E S-328-E
E-3 S-130-E (4) S-580-E (2)
E-82 S-132-E S-581-E
P-100-E S-326-E S-1542-C (3)

E-82 FILM GUIDE HOLDER ASSEMBLY (INCLUDED IN E-49)
N-261-E (4)

PARTS

C-127-E Film Guide Distance Collar (4)
> D-148-E Film Trap Door
G-125-E Intermittent Film Guide (Inside) (2)
G-126-E Intermittent Film Guide (Outside) (2)
K-150-E Film Trap Door Clamping Knob (2)
N-261-E Intermittent Film Guide Holder Stud Nut (4)
P-100-E Film Trap Door Pad
P-552-E Film Trap Door Protector
S-130-E Tension Shoe Spring Fastening Screw (4)
S-132-E Intermittent Film Guide Spring Fastening Screw
S-326-E Intermittent Film Guide Spring
S-328-E Film Trap Door Pad Spring
S-580-E Double Tension Shoe (2)
S-581-E Double Tension Shoe Spring
S-665-E Intermittent Film Guide Stud (2)
S-1157-E Removable Film Trap Door Bracket Fastening
Screw (Upper)
S-1159-E Removable Film Trap Door Bracket Fastening
Screw (Lower)
S-1511-E Intermittent Film Guide Stud Fastening Screw (4)
S-1542-C Film Trap Door Protector Fastening Screw (3)
W-231-D Intermittent Film Guide Stud Fastening Screw Washer

OLD STYLE PARTS STILL AVAILABLE E-10

D-145-E Film Trap Door
P-325-E Film Trap Door Protector
S-192-D Film Trap Door Protector Fastening Screw (2)

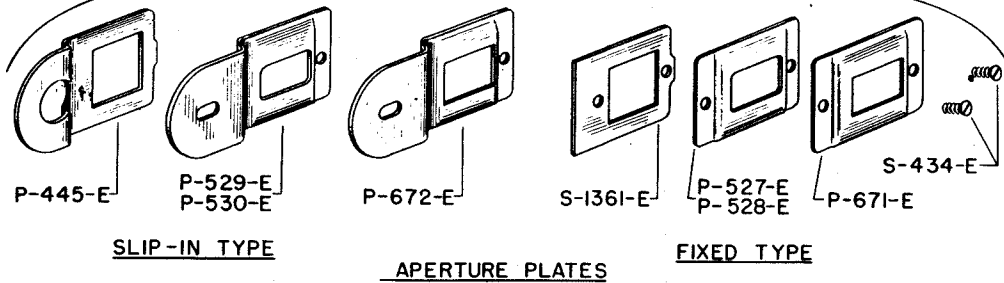
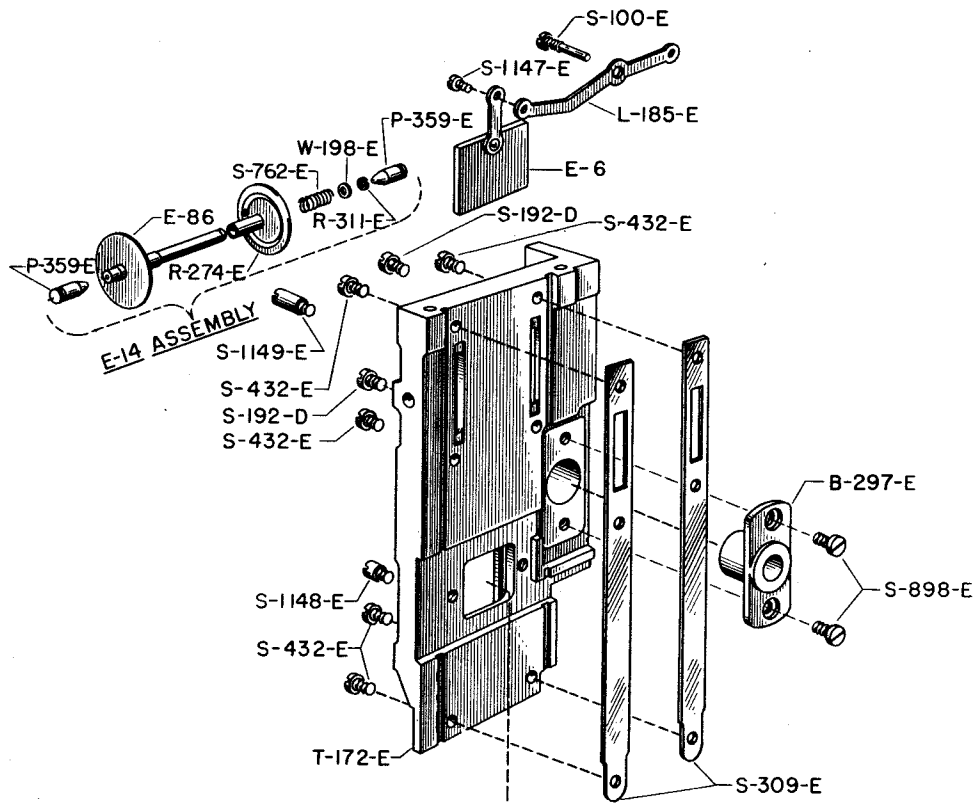

FILM TRAP

FILM TRAP

E-92 FILM TRAP COMPLETE

ASSEMBLIES

E-14 LATERAL GUIDE ROLLERS AND SHAFT ASSEMBLY

E-86 R-311-E W-198-E
R-214-E S-762-E

E-81 FILM TRAP AND BUSHING ASSEMBLY

B-297-E S-898-E (2) T-172-E

PARTS

B-297-E Film Trap Bushing
E-6 Automatic Fire Shutter and Lift Link
E-86 Lateral Guide Roller and Shaft
L-185-E Automatic Fire Shutter Lift Lever
P-359-E Lateral Guide Roller Pivot (2)
R-214-E Lateral Guide Roller
R-311-E Lateral Guide Roller Washer Retainer
S-100-E Automatic Fire Shutter Lift Lever Pivot Screw
S-192-D Lateral Guide Roller Pivot Fastening Screw (2)
S-309-E Film Trap Shoe (2)
S-432-E Film Trap Shoe Fastening Screw (6)
S-762-E Lateral Guide Roller Spring
S-898-E Film Trap Bushing Fastening Screw (2)
S-1147-E Automatic Fire Shutter Lift Link Screw
S-1148-E Automatic Fire Shutter Stop
S-1149-E Automatic Fire Shutter Lift Lever Stop
T-172-E Film Trap
W-198-E Lateral Guide Roller Spring Retaining Washer

FIXED AND SLIP-IN TYPE APERTURE PLATES FOR THE ABOVE FILM TRAP

FIXED TYPE

P-527-E Aperture Plate, Round Corners (.600" X .825")
P-528-E Aperture Plate, Round Corners (Undersize, .600" X .800")
P-671-E Aperture Plate, Square Corners (.600" X .825")
S-434-E Aperture Plate Fastening Screw (2)
S-1361-E Aperture Spacing Plate

SLIP-IN TYPE

P-445-E Aperture Plate Sliding Piece
P-529-E Aperture Plate, Round Corners (.600" X .825")
P-530-E Aperture Plate, Round Corners (Undersize, .600" X .800")
P-672-E Aperture Plate, Square Corners (.600" X .825")

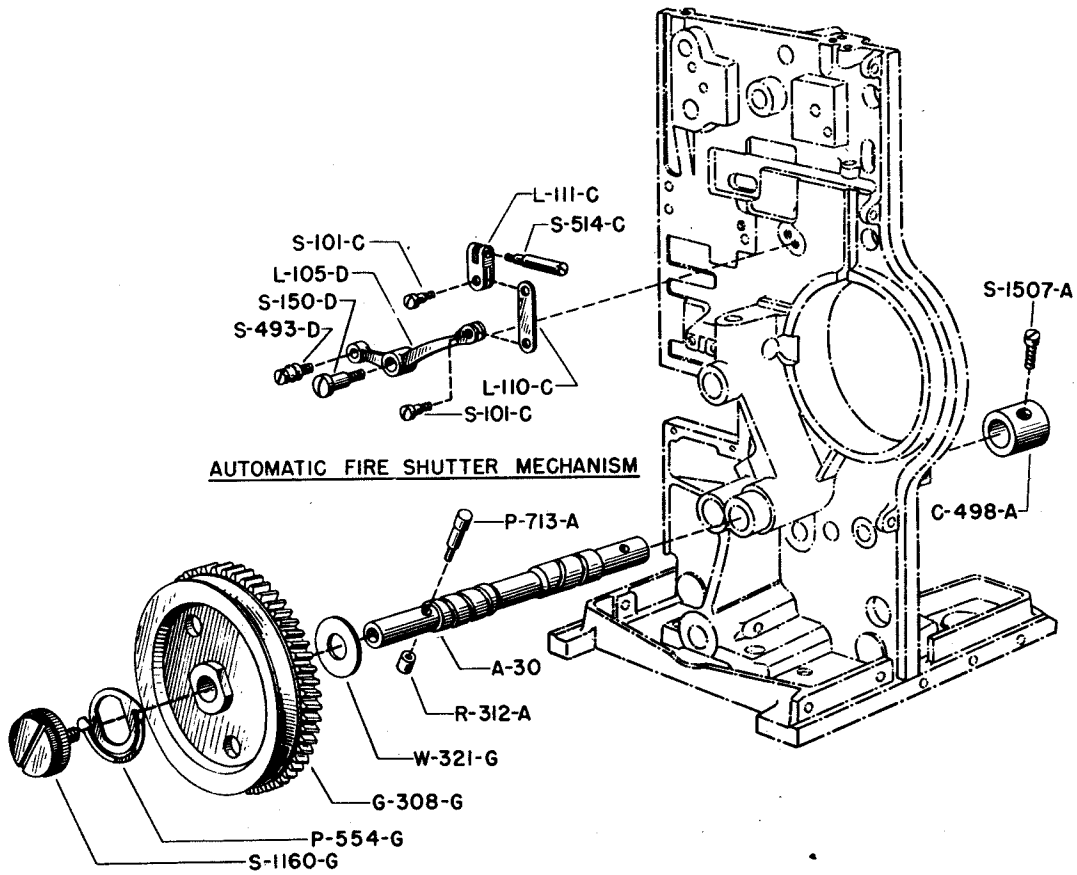

AUTOMATIC FIRE SHUTTER MECHANISM

**AUTOMATIC FIRE SHUTTER DEVICE
AND
MAIN DRIVE SHAFT AND GEAR**

AUTOMATIC FIRE SHUTTER DEVICE

PARTS

L-105-D	Governor Lift Lever
L-110-C	Governor Lift Lever Link
L-111-C	Governor Lift Lever Connecting Link
S-101-C	Automatic Fire Shutter Link Hinge Spring (2)
S-150-D	Governor Lift Lever Pivot Screw
S-493-D	Governor Lift Lever Screw
S-514-C	Fire Shutter Lifting Stud

MAIN DRIVE SHAFT

ASSEMBLIES

A-30 MAIN DRIVE SHAFT ASSEMBLY

P-713-A	Main Drive Shaft Pin
R-312-A	Main Drive Shaft Pin Retainer

PARTS

C-498-A	Main Drive Shaft Collar
G-308-G	Main Drive Gear
P-554-G	Main Drive Gear Retaining Screw Spring Pawl
S-1160-G	Main Drive Gear Retaining Screw
S-1507-A	Main Drive Shaft Collar Screw
W-321-G	Main Drive Gear Washer

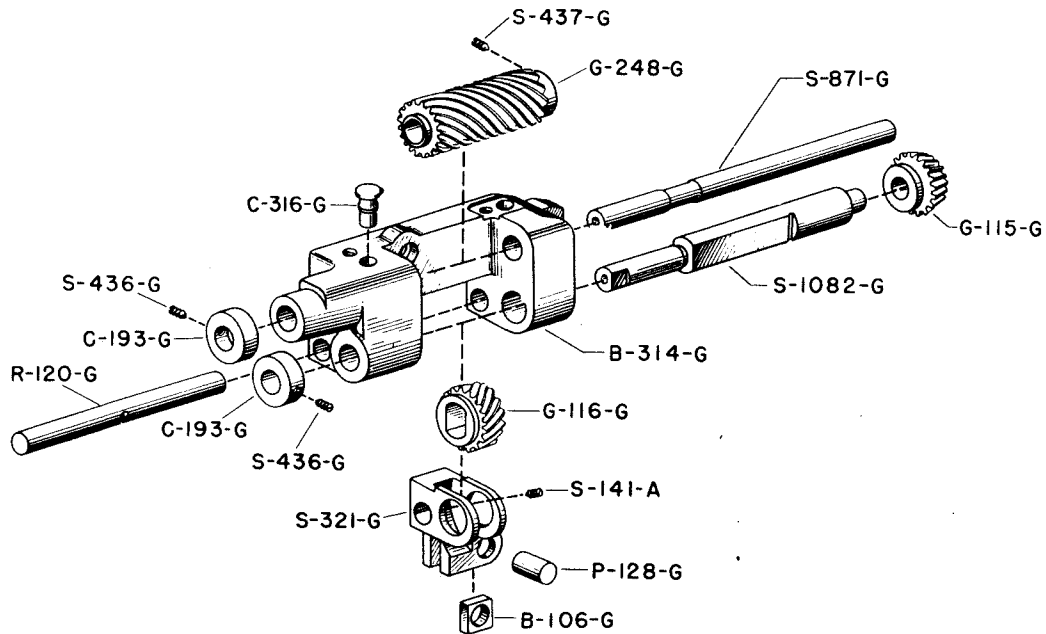

SHUTTER GEAR BRACKET

(Straight Type for Rear or Double Shutter Mechanisms)

G-40 SHUTTER GEAR BRACKET COMPLETE

ASSEMBLIES

G-4 FRAMING SLIDE AND BLOCK ASSEMBLY

B-106-G P-128-G S-321-G

G-5 STRAIGHT BEVEL GEAR AND SHAFT ASSEMBLY

C-193-G S-436-G S-1082-G
G-115-G

PARTS

B-106-G	Framing Slide Lever Block
B-314-G	Shutter Gear Bracket (INCLUDES C-316-G)
C-193-G	Shaft Collar (FOR S-871-G and S-1082-G) (2)
C-316-G	Oil Cup
G-115-G	Straight Bevel Gear
G-116-G	Shutter Drive Gear
G-248-G	Shutter Shaft Spiral Gear (Formica)
P-128-G	Framing Slide Lever Pin
R-120-G	Framing Slide Guide Rod
S-141-A	Framing Slide Set Screw
S-321-G	Framing Slide
S-436-G	Shaft Collar Set Screw (2)
S-437-G	Shutter Shaft Spiral Gear Set Screw
S-871-G	Shutter Shaft
S-1082-G	Bevel Gear Drive Shaft

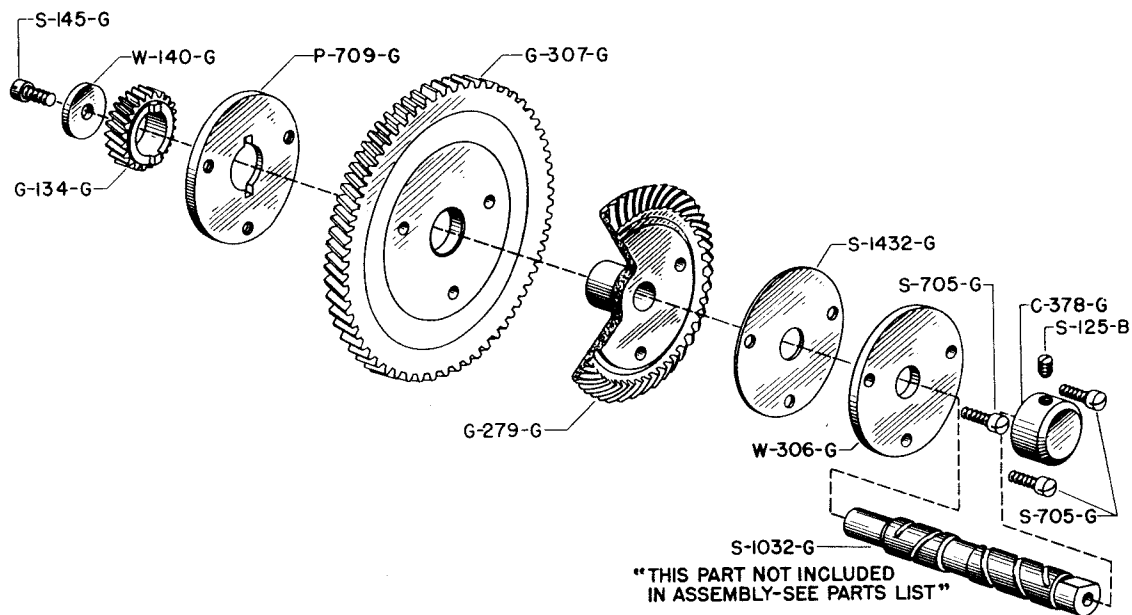

INTERMEDIATE GEAR AND ASSOCIATED PARTS

(SHOCKPROOF TYPE WITH SPIRAL BEVEL GEAR)

GG-5 SPIRAL BEVEL SHOCKPROOF INTERMEDIATE GEAR KIT COMPLETE

ASSEMBLIES

G-92 SHOCKPROOF INTERMEDIATE GEAR AND PLATE ASSEMBLY
 G-307-G P-709-G S-705-G (3)

PARTS

C-378-G	Intermediate Shaft Retaining Collar
G-134-G	Intermediate Small Steel Gear
G-279-G	Intermediate Spiral Bevel Gear
G-307-G	Shockproof Intermediate Gear
P-709-G	Intermediate Gear Plate
S-125-B	Intermediate Shaft Collar Screw
S-145-G	Intermediate Gear Washer Retaining Screw
S-705-G	Intermediate Gear Screw (3)
S-1432-G	Shim (Used only when required)
W-140-G	Intermediate Gear Washer (Outside)
W-306-G	Intermediate Gear Washer (Inside)

PARTS ILLUSTRATED BUT NOT INCLUDED IN ABOVE ASSEMBLY

S-1032-G Intermediate Shaft

NOTE: The S-1032-G Intermediate Shaft is not included in the GG-5 Kit and must be ordered as a separate item. It is available in the Standard Diameter or in any of the following oversizes: .001", .002", .003", .004" and .005". Specify the exact size desired. Otherwise the Standard Diameter will be furnished.

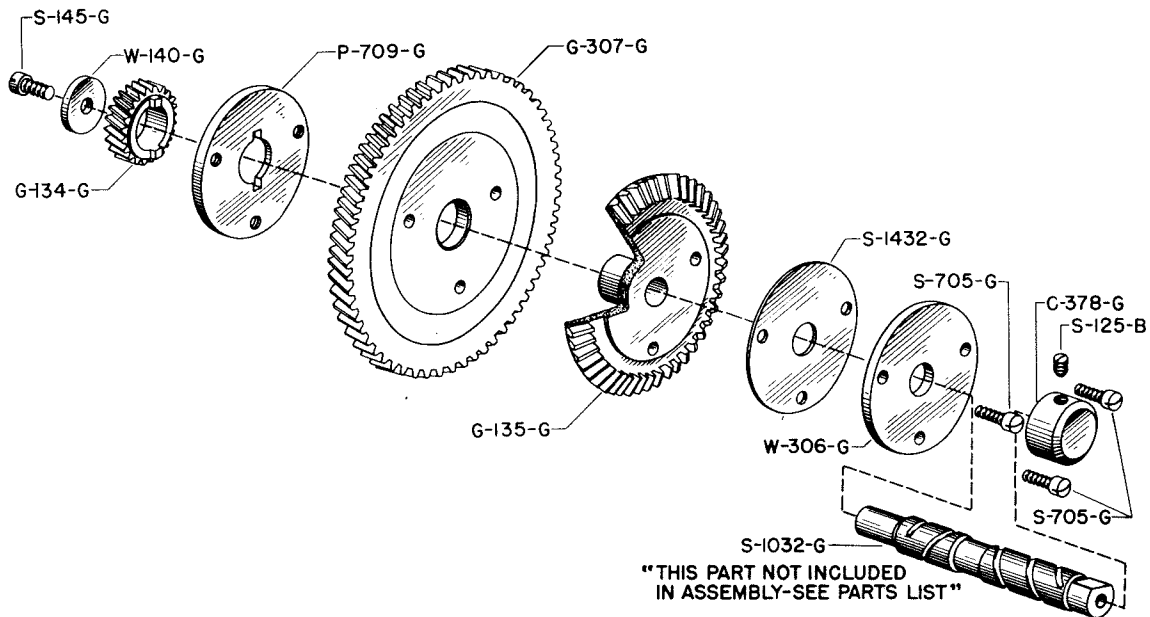

INTERMEDIATE GEAR AND ASSOCIATED PARTS

(SHOCKPROOF TYPE WITH STRAIGHT BEVEL GEAR)

GG-6 STRAIGHT BEVEL SHOCKPROOF INTERMEDIATE GEAR KIT COMPLETE

ASSEMBLIES

G-92 SHOCKPROOF INTERMEDIATE GEAR AND PLATE ASSEMBLY

G-307-G P-709-G S-705-G (3)

PARTS

C-378-G	Intermediate Shaft Retaining Collar
G-134-G	Intermediate Small Steel Gear
G-135-G	Intermediate Straight Bevel Gear
G-307-G	Shockproof Intermediate Gear
P-709-G	Intermediate Gear Plate
S-125-B	Intermediate Shaft Collar Screw
S-145-G	Intermediate Gear Washer Retaining Screw
S-705-G	Intermediate Gear Screw (3)
S-1432-G	Shim (Used only when required)
W-140-G	Intermediate Gear Washer (Outside)
W-306-G	Intermediate Gear Washer (Inside)

PARTS ILLUSTRATED BUT NOT INCLUDED IN ABOVE ASSEMBLY

S-1032-G Intermediate Shaft

NOTE: The S-1032-G Intermediate Shaft is not included in the GG-6 Kit and must be ordered as a separate item. It is available in the Standard Diameter or in any of the following Oversizes: .001", .002", .003", .004" and .005". Specify the exact size desired. Otherwise the Standard Diameter will be furnished.

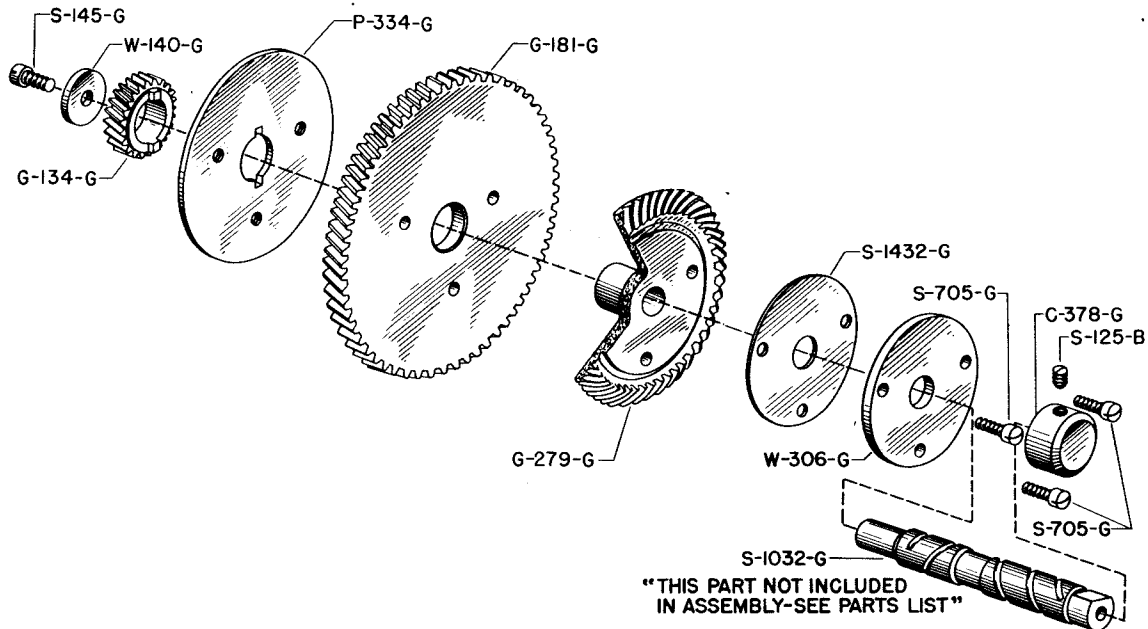

INTERMEDIATE GEAR AND ASSOCIATED PARTS

(FORMICA TYPE WITH SPIRAL BEVEL GEAR)

GG-9 FORMICA INTERMEDIATE GEAR KIT COMPLETE

ASSEMBLIES

G-12 FORMICA INTERMEDIATE GEAR AND PLATE ASSEMBLY
 G-181-G P-334-G S-705-G (3)

PARTS

C-378-G	Intermediate Shaft Retaining Collar
G-134-G	Intermediate Small Steel Gear
G-181-G	Formica Intermediate Gear
G-279-G	Intermediate Spiral Bevel Gear
P-334-G	Intermediate Gear Plate
S-125-B	Intermediate Shaft Collar Screw
S-145-G	Intermediate Gear Washer Retaining Screw
S-705-G	Intermediate Gear Screw (3)
S-1432-G	Shim (Used only when required)
W-140-G	Intermediate Gear Washer (Outside)
W-306-G	Intermediate Gear Washer (Inside)

PARTS ILLUSTRATED BUT NOT INCLUDED IN ABOVE ASSEMBLY

S-1032-G Intermediate Shaft

NOTE: The S-1032-G Intermediate Shaft is not included in the GG-9 Kit and must be ordered as a separate item. It is available in the Standard Diameter or in any of the following Oversizes: .001", .002", .003", .004" and .005". Specify the exact size desired. Otherwise the Standard Diameter will be furnished.

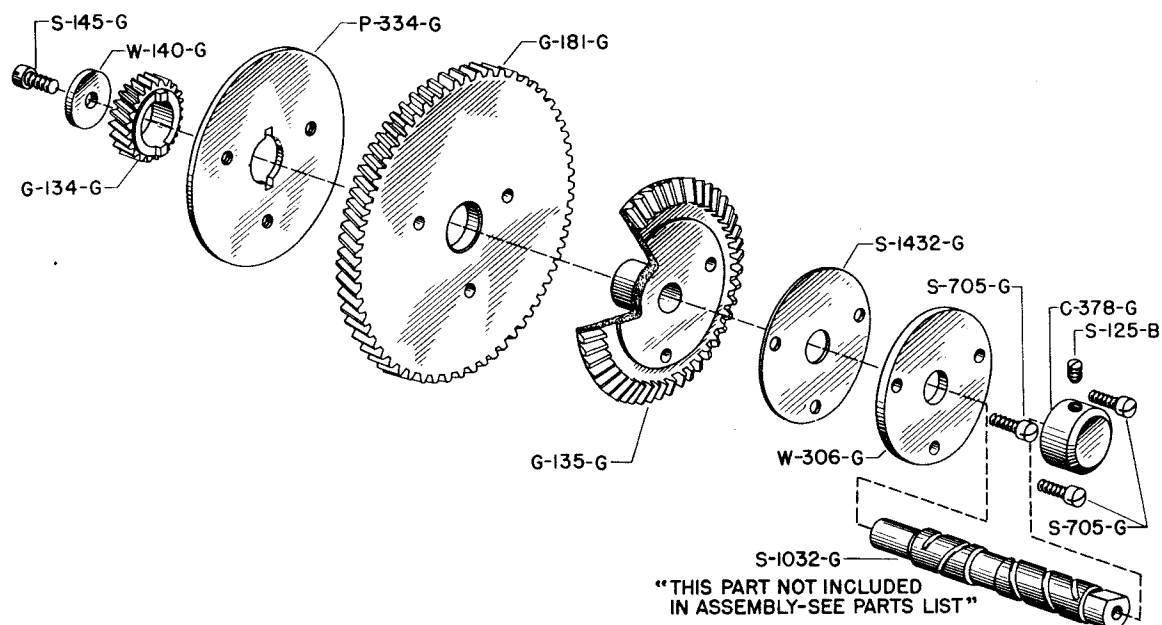

INTERMEDIATE GEAR AND ASSOCIATED PARTS
(FORMICA TYPE WITH STRAIGHT BEVEL GEAR)

GG-10 FORMICA INTERMEDIATE GEAR KIT COMPLETE

ASSEMBLIES

- G-12 FORMICA INTERMEDIATE GEAR AND PLATE ASSEMBLY**
 G-181-G P-334-G S-705-G (3)

PARTS

- | | |
|----------|--|
| C-378-G | Intermediate Shaft Retaining Collar |
| G-134-G | Intermediate Small Steel Gear |
| G-135-G | Intermediate Straight Bevel Gear |
| G-181-G | Formica Intermediate Gear |
| P-334-G | Intermediate Gear Plate |
| S-125-B | Intermediate Shaft Collar Screw |
| S-145-G | Intermediate Gear Washer Retaining Screw |
| S-705-G | Intermediate Gear Screw (3) |
| S-1432-G | Shim (Used only when required) |
| W-140-G | Intermediate Gear Washer (Outside) |
| W-306-G | Intermediate Gear Washer (Inside) |

PARTS ILLUSTRATED BUT NOT INCLUDED IN ABOVE ASSEMBLY

- S-1032-G Intermediate Shaft

NOTE: The S-1032-G Intermediate Shaft is not included in the GG-10 kit and must be ordered as a separate item. It is available in the Standard Diameter or in any of the following oversizes: .001", .002", .003", .004" and .005". Specify the exact size desired. Otherwise the standard Diameter will be furnished.

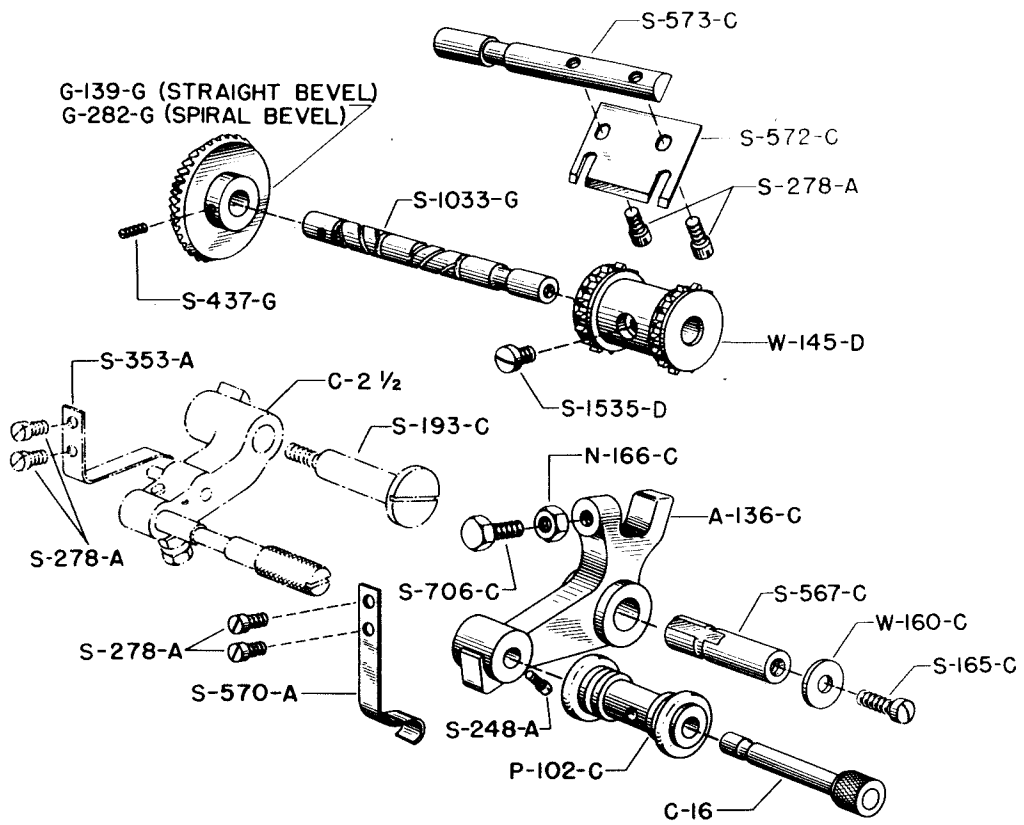

UPPER SPROCKET AND ASSOCIATED PARTS

UPPER SPROCKET AND ASSOCIATED PARTS

PARTS

A-136-C	Upper Pad Roller Arm	
C-16	Pad Roller Stud and Knob	
G-139-G	Upper Sprocket Shaft Gear - Straight Bevel	
G-282-G	Upper Sprocket Shaft Gear - Spiral Bevel	
N-166-C	Pad Roller Arm Adjusting Nut	
P-102-C	Pad Roller	
S-165-C	Pad Roller Arm Stud Washer Retaining Screw	
S-248-A	Pad Roller Stud and Knob Retaining Screw	
S-278-A	Fastening Screw (FOR S-570-A and S-572-C) (4)	
S-437-G	Upper Sprocket Shaft Gear Fastening Screw	
S-567-C	Pad Roller Arm Stud	
S-570-A	Upper Pad Roller Arm Spring	
S-572-C	Upper Sprocket Stripper Plate	
S-573-C	Upper Sprocket Stripper Plate Stud	
S-706-C	Pad Roller Arm Adjusting Screw	
S-1033-G	Upper Sprocket Shaft - Regular	
S-1033-G	Upper Sprocket Shaft - .0015 Oversize)	WHEN
S-1033-G	Upper Sprocket Shaft - .0025 Oversize)	ORDERING
S-1033-G	Upper Sprocket Shaft - .0035 Oversize)	SPECIFY
S-1033-G	Upper Sprocket Shaft - .0045 Oversize)	SIZE
S-1033-G	Upper Sprocket Shaft - .0055 Oversize)	REQUIRED
S-1535-D	Upper Sprocket Fastening Screw	
→ W-145-D	Upper Sprocket LA Y E Z Z I # 416 G L 31 B	
W-160-C	Pad Roller Arm Stud Retaining Washer	

OLD STYLE PARTS STILL AVAILABLE

C-2½	Upper Pad Roller Arm Assembly
S-193-C	Upper Pad Roller Arm Stud
S-278-A	Upper Pad Roller Arm Spring Fastening Screw (2)
S-353-A	Upper Pad Roller Arm Spring

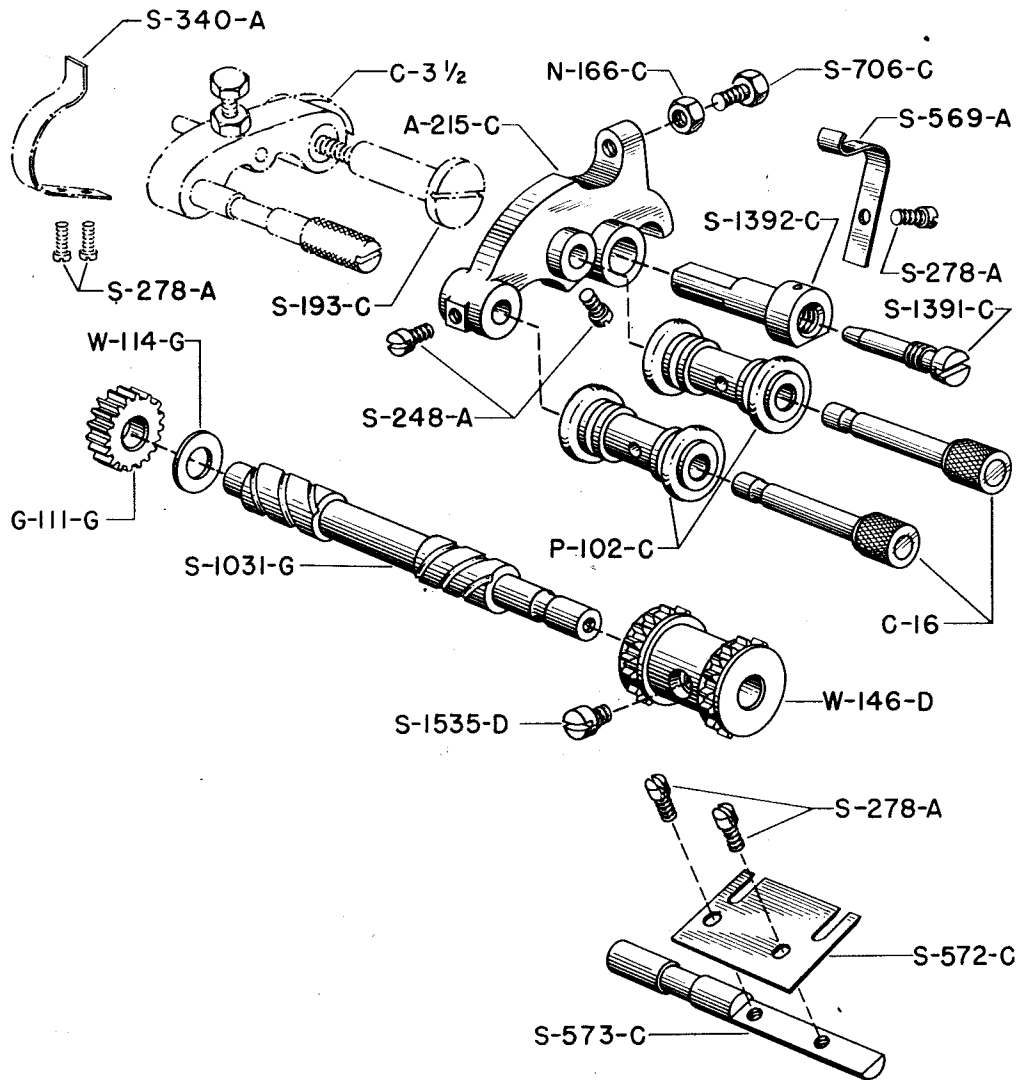

LOWER SPROCKET AND ASSOCIATED PARTS

LOWER SPROCKET AND ASSOCIATED PARTS

ASSEMBLIES

C-21 LOWER PAD ROLLER ARM ASSEMBLY

A-215-C Lower Pad Roller Arm
C-16 Lower Pad Roller Arm Stud and Knob (2)
N-166-C Lower Pad Roller Arm Adjusting Nut
P-102-C Pad Roller (2)
S-248-A Pad Roller Stud and Knob Retaining Screw (2)
S-706-C Pad Roller Arm Adjusting Screw

C-59 PAD ROLLER ARM STUD AND SCREW ASSEMBLY

S-1391-C Pad Roller Arm Stud Screw
S-1392-C Pad Roller Arm Stud

G-35 LOWER SPROCKET SHAFT AND GEAR ASSEMBLY (See note below)

G-111-G Lower Sprocket Shaft Gear
S-1031-G Lower Sprocket Shaft
W-114-G Lower Sprocket Shaft Washer

NOTE: The G-35 Assembly is made up with S-1031-G Shaft in the Standard Diameter or in any of the following Oversizes: .001", .002", .003", .004" and .005". In ordering either the G-35 Assembly or the S-1031-G Part, specify the exact size desired. Otherwise the Standard Diameter will be furnished.

PARTS

S-278-A Fastening Screw (For S-272-C and S-569-A) (3)
S-569-A Lower Sprocket Arm Spring
S-572-C Lower Sprocket Stripper Plate
S-573-C Lower Sprocket Stripper Plate Stud
S-1535-D Lower Sprocket Fastening Screw
→ W-146-D Lower Sprocket LAVEZZI # 416 GL31B

OLD STYLE PARTS STILL AVAILABLE

C-3½ Lower Sprocket Arm Assembly
S-278-A Lower Sprocket Arm Spring Fastening Screw (2)
S-340-A Lower Sprocket Arm Spring

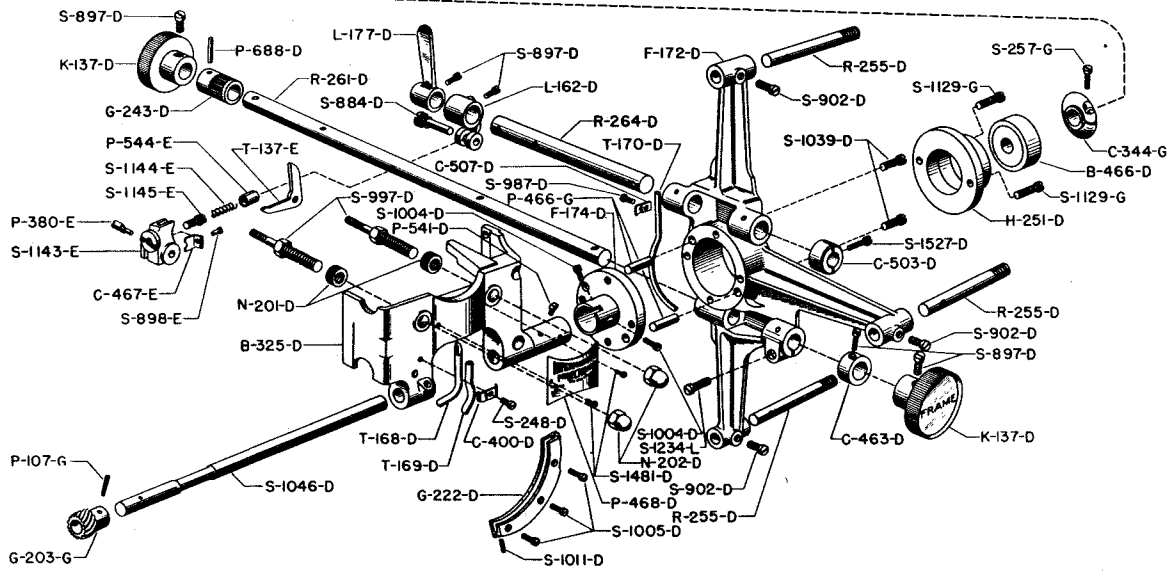
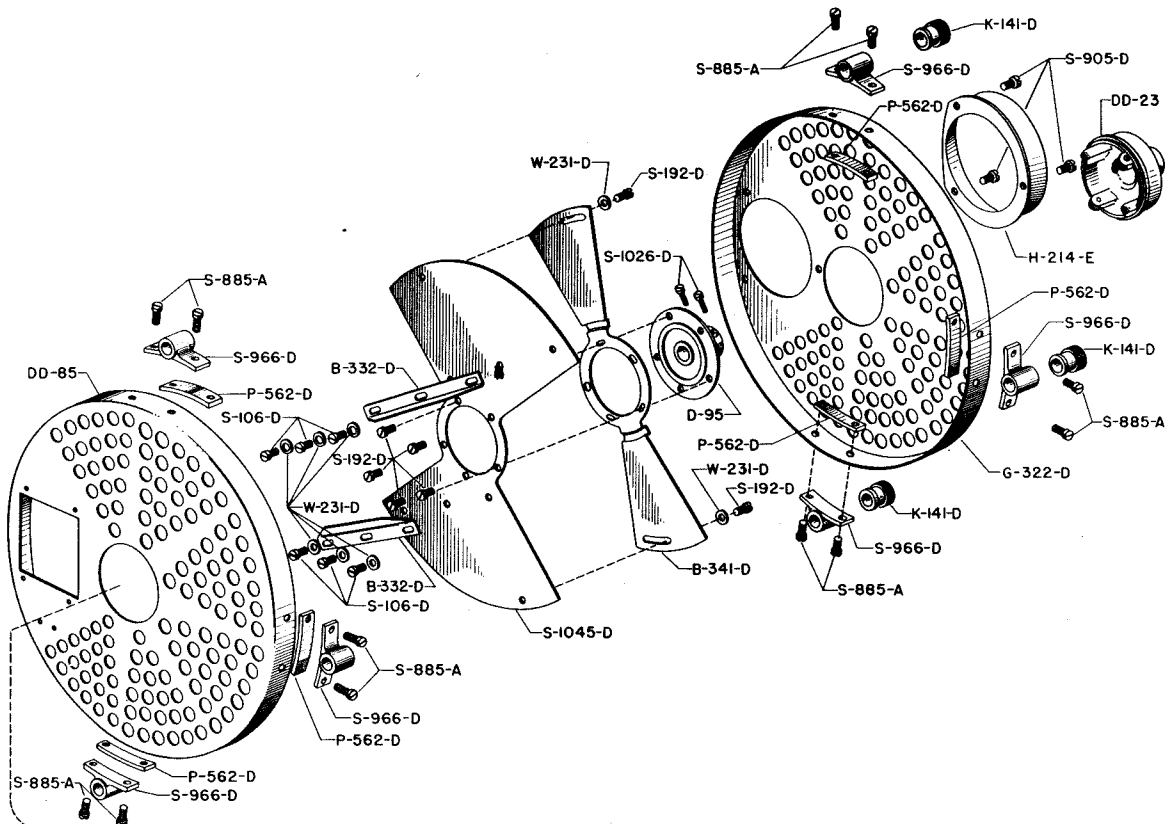

REAR SHUTTER

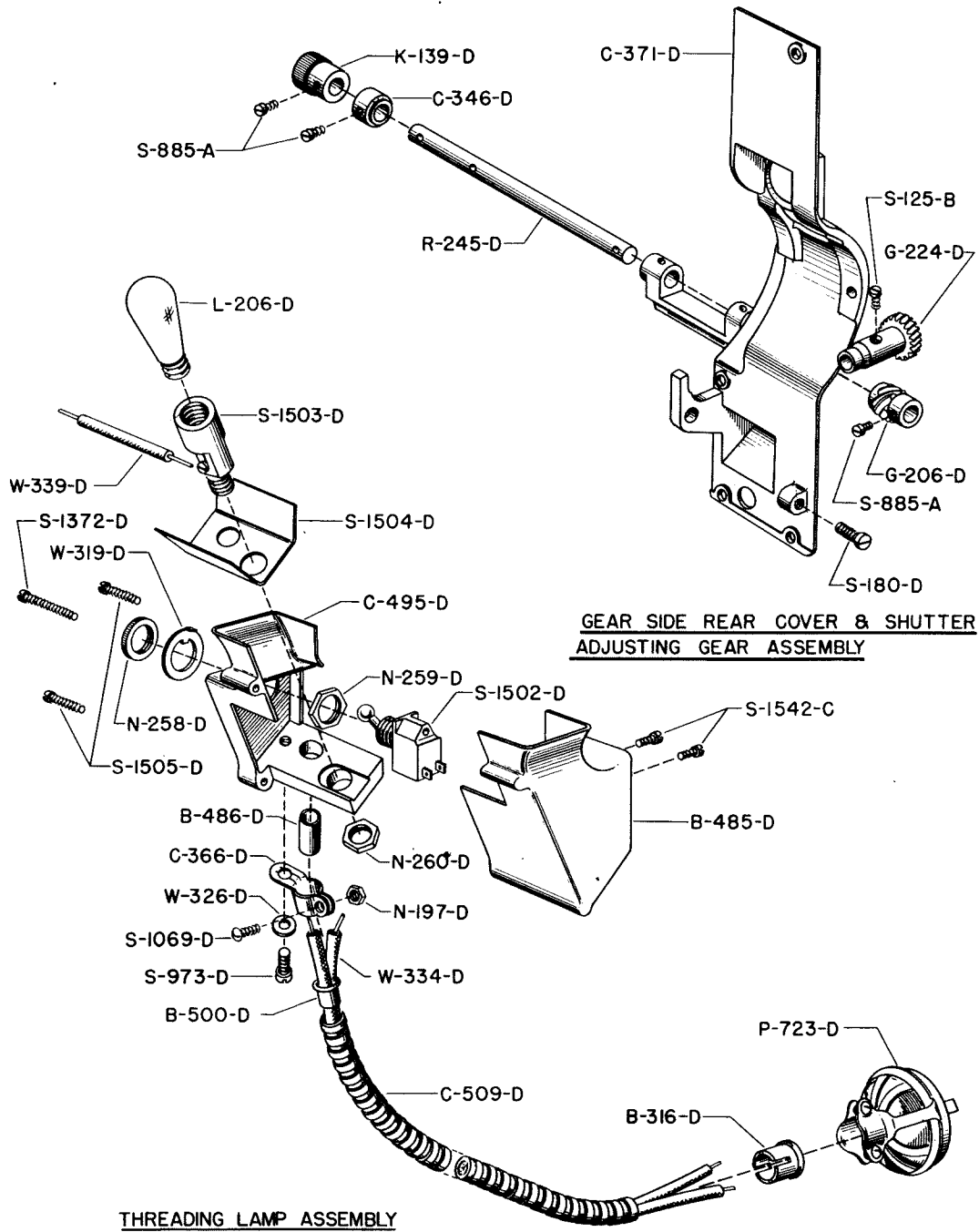

REAR SHUTTER

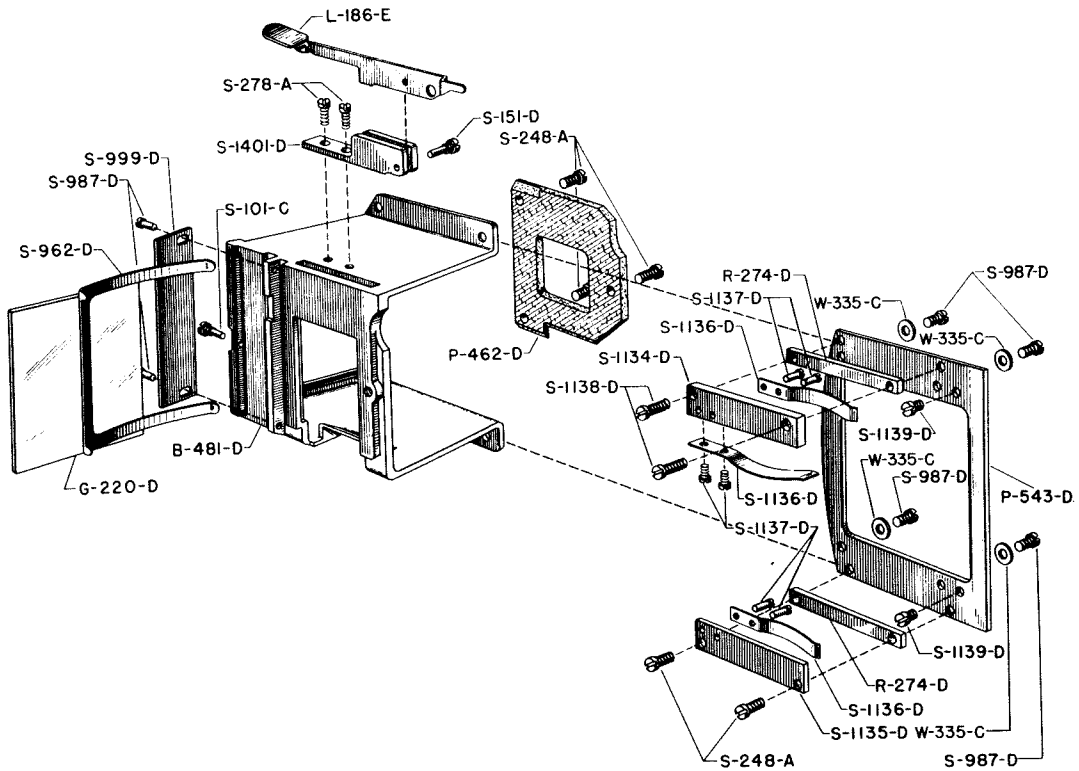

REAR SHUTTER

D-90 REAR SHUTTER ATTACHMENT COMPLETE.

ASSEMBLIES

D-74	REAR SHUTTER GUARD ASSEMBLY (Front Section)			
DD-85	P-562-D(3)	S-885-D(6)	S-966-D(3)	
D-75	REAR SHUTTER GUARD ASSEMBLY (Rear Section)			
G-322-D	P-562-D(3)	S-885-D(6)	S-966-D(3)	
D-80	SHUTTER SHAFT AND GEAR ASSEMBLY			
G-203-D	P-107-G	S-1046-D		
D-86	SPOT SIGHT BOX ASSEMBLY			
B-481-D	P-462-D	S-248-A(3)	S-987-D(2)	
G-220-D	S-101-C	S-278-A(2)	S-999-D	
L-186-D	S-151-D	S-962-D	S-1401-D	

REAR SHUTTER (continued)

D-89	TWO-WING ADJUSTABLE SHUTTER ASSEMBLY			
	B-332-D(2)	S-106-D(6)	S-1045-D	
	B-341-D	S-192-D(2)	W-231-D(8)	
D-91	FRAMING CAM GEAR ASSEMBLY			
	G-222-D	S-1005-D(3)	S-1011-D	
D-92	REAR SHUTTER BRACKET STUD ASSEMBLY (2)			
	N-201-D	N-202-D	S-997-D	
D-93	GEAR SIDE REAR COVER AND SHUTTER ADJUSTING GEAR ASSEMBLY			
	C-346-D	G-206-D	R-245-D	
	C-371-D	K-139-D	S-885-D(3)	
D-94	SHUTTER ADJUSTING GEAR ASSEMBLY (Driven Gear)			
	G-224-D	P-420-G	S-125-B	
D-95	SHUTTER SPIDER ASSEMBLY			
	S-1026-D(2)			
DD-4	SPOT SIGHT BOX MOUNT ASSEMBLY			
	P-543-D	S-987-D(4)	S-1136-D(3)	S-1139-D(2)
	R-274-D(2)	S-1134-D	S-1137-D(6)	W-335-C(4)
	S-248-D(2)	S-1135-D	S-1138-D(2)	
DD-7	REAR SHUTTER BRACKET ASSEMBLY			
	B-325-D	P-468-D	S-248-A	T-168-D
	C-400-D	P-541-D	S-1481-D(2)	T-169-D
DD-8	REAR SHUTTER BRACKET BALL BEARING ASSEMBLY			
	B-466-D	G-28	P-466-G(2)	S-1039-D(2)
	F-174-D	H-251-D	P-541-D	S-1129-D(2)
DD-73	FRAMING LAMP ASSEMBLY			
	B-316-D	C-509-D	P-723-D	S-1504-D
	B-485-D	L-206-D	S-973-D	S-1505-D(2)
	B-486-D	N-197-D	S-1069-D	W-319-D
	B-500-D	N-258-D	S-1372-D	W-326-D
	C-366-D	N-259-D	S-1502-D	W-334-D(2)
	C-495-D	N-260-D	S-1503-D	W-339-D
E-43	FILM TRAP DOOR LOCK			
	C-467-E	P-544-E	S-1143-E	S-1145-E
	P-380-E	S-898-E	S-1144-E	T-137-E
G-28	SHUTTER SHAFT CLAMP COLLAR ASSEMBLY (Included in DD-8)			
	C-344-G	S-257-G		

REAR SHUTTER (continued)

PARTS

B-316-D	Framing Lamp Cable Bushing
B-325-D	Rear Shutter Bracket
B-332-D	Shutter Fan Blade (2)
B-341-D	Shutter Adjustable Blade
B-466-D	Rear Shutter Bracket Ball Bearing
B-481-D	Spot Sight Box
B-485-D	Framing Lamp Box
B-486-D	Framing Lamp Bushing
B-500-D	Framing Lamp Cable Wire Safety Bushing
C-344-G	Shutter Shaft Clamp Collar
C-346-D	Shutter Adjusting Gear Rod Collar
C-366-D	Framing Lamp Cable Clamp
C-371-D	Gear Side Rear Cover
C-400-D	Rear Shutter Bracket Oil Tube Clamp
C-463-D	Framing Gear Handle Rod Collar
C-467-E	Door Lock Pawl Pivot Clamp
C-495-D	Framing Lamp Box Cover
C-503-D	Film Trap Door Opening Rod Collar
C-507-D	Shutter Guard Support Frame Oil Tube Clamp
C-509-D	Flexible Conduit (4 Feet)
DD-23	Rear Shutter Light Cap
DD-85	Rear Shutter Guard (Front Section)
F-172-D	Shutter Guard Support Frame
F-174-D	Rear Shutter Bracket Flange
G-203-G	Shutter Shaft Gear
G-206-D	Shutter Adjusting Gear (Driving)
G-220-D	Spot Sight Glass
G-222-D	Framing Cam Gear
G-224-D	Shutter Adjusting Gear (Driven)
G-243-D	Framing Gear
G-322-D	Rear Shutter Guard (Rear Section)
H-214-E	Fire Shield Hood
H-251-D	Ball Bearing Housing
K-137-D	Framing Gear Handle Knob (2)
K-139-D	Shutter Adjusting Gear Knob
K-141-D	Cover Holding Support Rod Knob (3)
L-162-D	Film Trap Door Opening Lever
L-177-D	Film Trap Door Lever
L-186-D	Automatic Fire Shutter Lift Lever
L-206-D	Mazda Lamp (6S6, 120V, Clear)

REAR SHUTTER (continued)

N-197-D Framing Lamp Cable Clamp Nut
N-201-D Rear Shutter Bracket Stud Knurled Nut (2)
N-202-D Rear Shutter Bracket Stud Cap Nut (2)
N-258-D Lock Nut (For S-1502-D Switch)
N-259-D Hexagon Lock Nut (For S-1502-D Switch)
N-260-D Retaining Nut (For S-1503-D Lamp Socket)
P-107-G Shutter Shaft Gear Pin
P-380-E Door Lock Pawl Pivot
P-462-D Cooling Plate
P-466-G Rear Shutter Bracket Flange Dowel Pin (2)
P-468-D Rear Shutter Bracket Name Plate
P-541-D Rear Shutter Bracket Flange Locating Pin
P-543-D Spot Sight Box Seating Plate
P-544-E Door Lock Plunger
P-562-D Shutter Guard Holding Support Plate (6)
P-688-D Framing Rod Gear Pin
P-723-D AC Supply Plug
R-245-D Shutter Adjusting Gear Rod
R-255-D Cover Holding Support Rod (3)
R-261-D Framing Gear Handle Rod
R-264-D Film Trap Door Opening Rod
R-274-D Spot Sight Box Guide Rail (2)
S-101-C Spot Sight Glass Retaining Screw
S-106-D Shutter Fan Blade Screw (6)
S-125-B Shutter Adjusting Gear Set Screw
S-151-D Automatic Fire Shutter Lift Lever Pivot Screw
S-180-D Gear Side Rear Door Locking Screw
S-192-D Shutter Fastening Screw (7)
S-248-A Fastening Screw (For C-400-D, P-462-D and S-1135-D) (6)
S-257-G Shutter Shaft Clamp Collar Screw
S-278-A Fire Shutter Lift Support Fastening Screw (2)
S-884-D Door Opening Lever Stop Screw
S-885-A Fastening Screw (For C-346-D, G-206-D, K-139-D & S-966-D) (15)
S-897-D Fastening Screw (For C-463-D, K-137-D, L-162-D & L-177-D) (5)
S-898-E Door Lock Pawl Pivot Lock Screw
S-902-D Cover Holding Support Rod Fastening Screw (3)
S-905-D Fire Shield Hood Fastening Screw (3)
S-962-D Spot Sight Glass Tension Spring
S-966-D Shutter Guard Holding Support (6)
S-973-D Framing Lamp Cable Clamp Fastening Screw

REAR SHUTTER (continued)

S-987-D Fastening Screw (For C-507-D, P-543-D & S-999-D) (7)
S-997-D Rear Shutter Bracket Stud (2)
S-999-D Light Seal
S-1004-D Rear Shutter Bracket Flange Retaining Screw (2)
S-1005-D Framing Cam Gear Set Screw (3)
S-1011-D Framing Cam Stop Stud
S-1026-D Shutter Spider Clamp Screw (2)
S-1039-D Rear Shutter Bracket Fastening Screw (For F-174-D) (2)
S-1045-D Shutter Main Blade
S-1046-D Shutter Shaft
S-1069-D Framing Lamp Cable Clamp Screw
S-1129-G Ball Bearing Housing Fastening Screw (2)
S-1134-D Upper Retaining Strip
S-1135-D Lower Retaining Strip
S-1136-D Spot Sight Box Retaining Spring (3)
S-1137-D Spot Sight Box Retaining Spring Fastening Screw (6)
S-1138-D Upper Retaining Strip Fastening Screw (2)
S-1139-D Spot Sight Box Stop Screw (2)
S-1143-E Door Lock Trigger Support
S-1144-E Door Lock Plunger Spring
S-1145-E Door Lock Fastening Screw
S-1234-L Shutter Guard Support Frame Clamp Screw
S-1372-D Framing Lamp Box Cover Fastening Screw (Long)
S-1401-D Fire Shutter Lift Lever Support
S-1452-C Fastening Screw (For DD-73 Framing Lamp Assembly) (2)
S-1481-D Name Plate Fastening Screw (Self-Threading) (2)
S-1502-D Framing Lamp Switch
S-1503-D Framing Lamp Socket
S-1504-D Framing Lamp Shield
S-1505-D Framing Lamp Box Cover Fastening Screw (Short) (2)
S-1527-D Film Trap Door Opening Rod Collar Fastening Screw
T-137-E Door Lock Trigger
T-168-D Rear Shutter Bracket Oil Tube (Long)
T-169-D Rear Shutter Bracket Oil Tube (Short)
T-170-D Shutter Support Frame Oil Tube
W-231-D Shutter Fan Blade Screw Washer (8)
W-319-D Framing Lamp Switch Washer
W-326-D Cable Clamp Washer
W-334-D Flexible Wire (4 Feet 7 Inches) (2)
W-335-C Seating Plate Fastening Screw Washer (4)
W-339-D Flexible Wire (2 Inches)

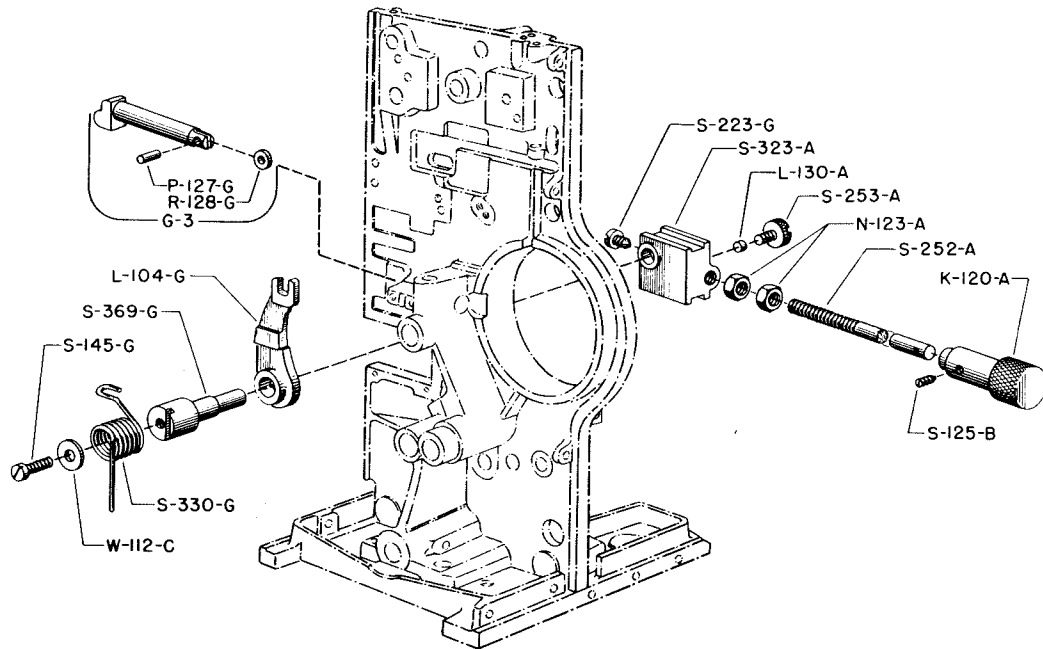

SHUTTER ADJUSTING AND FRAMING DEVICES

ASSEMBLIES

A-2 SHUTTER ADJUSTING SCREW AND KNOB ASSEMBLY

K-120-A	Shutter Adjusting Screw Knob
S-125-B	Shutter Adjusting Screw Knob Set Screw
S-252-A	Shutter Adjusting Screw

G-3 FRAMING SLIDE ARM AND ROLLER ASSEMBLY

P-127-G	Framing Slide Arm Roller Pin
R-128-G	Framing Slide Arm Roller

PARTS

L-104-G	Framing Slide Lever
L-130-A	Shutter Adjustment Slide Stop Screw Lock
N-123-A	Shutter Adjusting Lock Nut (2)
S-145-G	Framing Slide Lever Spring Retaining Screw
S-223-G	Framing Slide Lever Stud Set Screw
S-253-A	Shutter Adjusting Slide Lock Screw
S-323-A	Shutter Adjusting Slide
S-330-G	Framing Slide Lever Spring
S-369-G	Framing Slide Lever Stud
W-112-G	Washer (For S-145-G Screw)

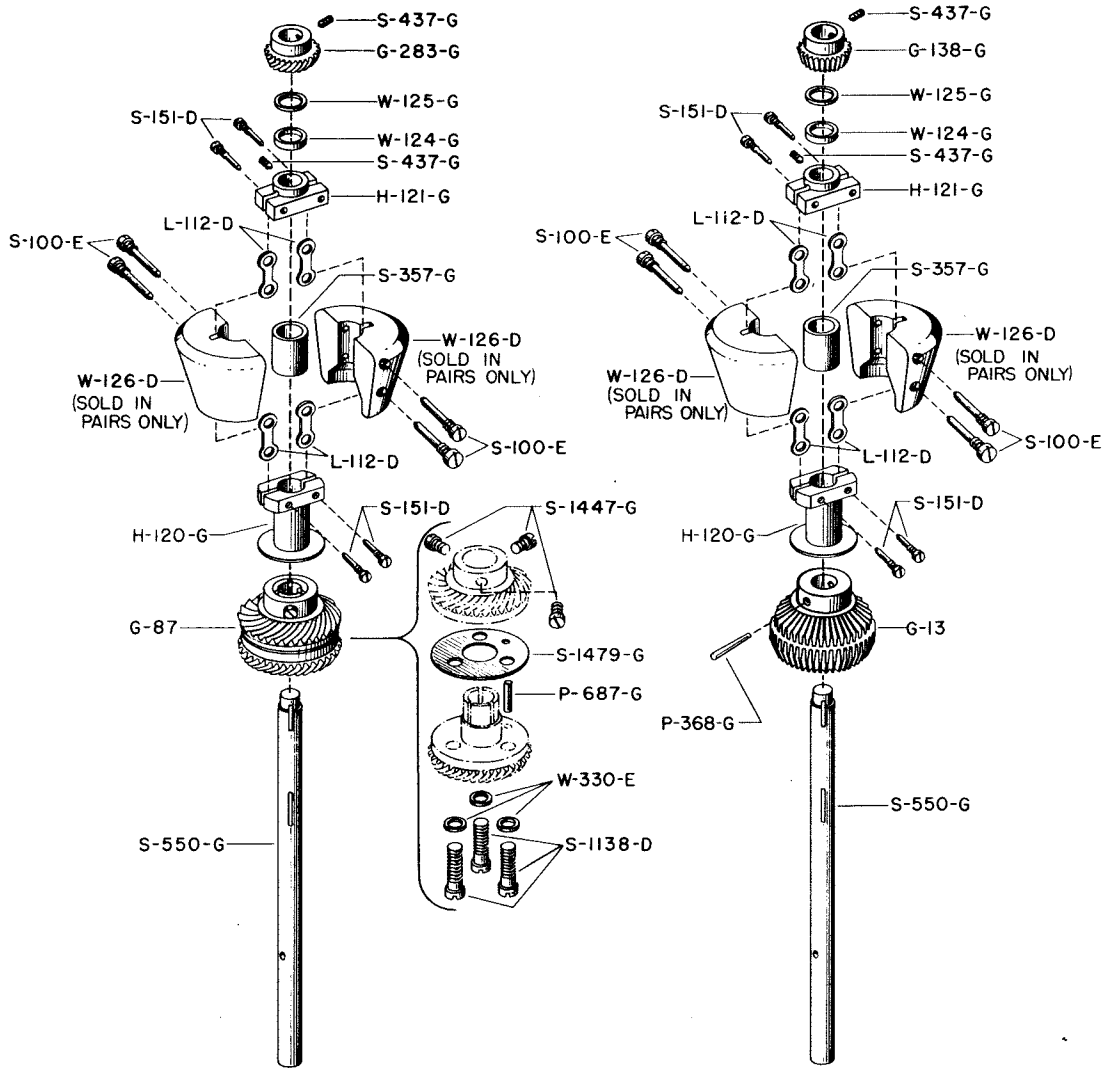

VERTICAL SHAFT
(WITH SPIRAL BEVEL GEARS)

VERTICAL SHAFT
(WITH STRAIGHT BEVEL GEARS)

VERTICAL SHAFT AND ASSOCIATED PARTS

VERTICAL SHAFT AND ASSOCIATED PARTS

ASSEMBLIES

D-3 GOVERNOR WEIGHT AND LINK ASSEMBLY

L-112-D Governor Weight Link (2)
S-100-E Governor Weight Link Screw (4)
W-126-D Governor Weight (Sold in Matched Pairs only) (2)

G-15 STRAIGHT DOUBLE BEVEL GEAR AND SHAFT ASSEMBLY

G-13 Straight Double Bevel Gear
P-368-G Straight Double Bevel Gear Taper Pin
S-550-G Vertical Shaft

G-64 SPIRAL DOUBLE BEVEL GEAR AND SHAFT ASSEMBLY

G-87 Spiral Double Bevel Gear and Clamp
S-550-G Vertical Shaft

G-87 SPIRAL DOUBLE BEVEL GEAR AND CLAMP ASSEMBLY (Included in G-64)

P-687-G Double Bevel Gear Locating Dowel Pin
S-1138-D Double Bevel Gear Fastening Screw (3)
S-1447-G Double Bevel Gear Clamp Collar Screw (3)
S-1479-G Double Bevel Gear Shim (Optional—used only when required)
W-330-E Double Bevel Gear Fastening Screw Washer (3)

PARTS

G-138-G Straight Bevel Gear
G-283-G Spiral Bevel Gear
H-120-G Governor Link Holder (Lower)
H-121-G Governor Link Holder (Upper)
S-151-D Governor Link Holder Screw (4)
S-357-G Governor Weight Stop
S-437-G Fastening Screw (For H-121-G, G-138-G and G-283-G) (2)
S-1479-G Double Spiral Bevel Gear Shim (.026")
S-1482-G Double Spiral Bevel Gear Shim (.015") Shims used
S-1483-G Double Spiral Bevel Gear Shim (.008") only when
S-1484-G Double Spiral Bevel Gear Shim (.005") required.
S-1485-G Double Spiral Bevel Gear Shim (.003")

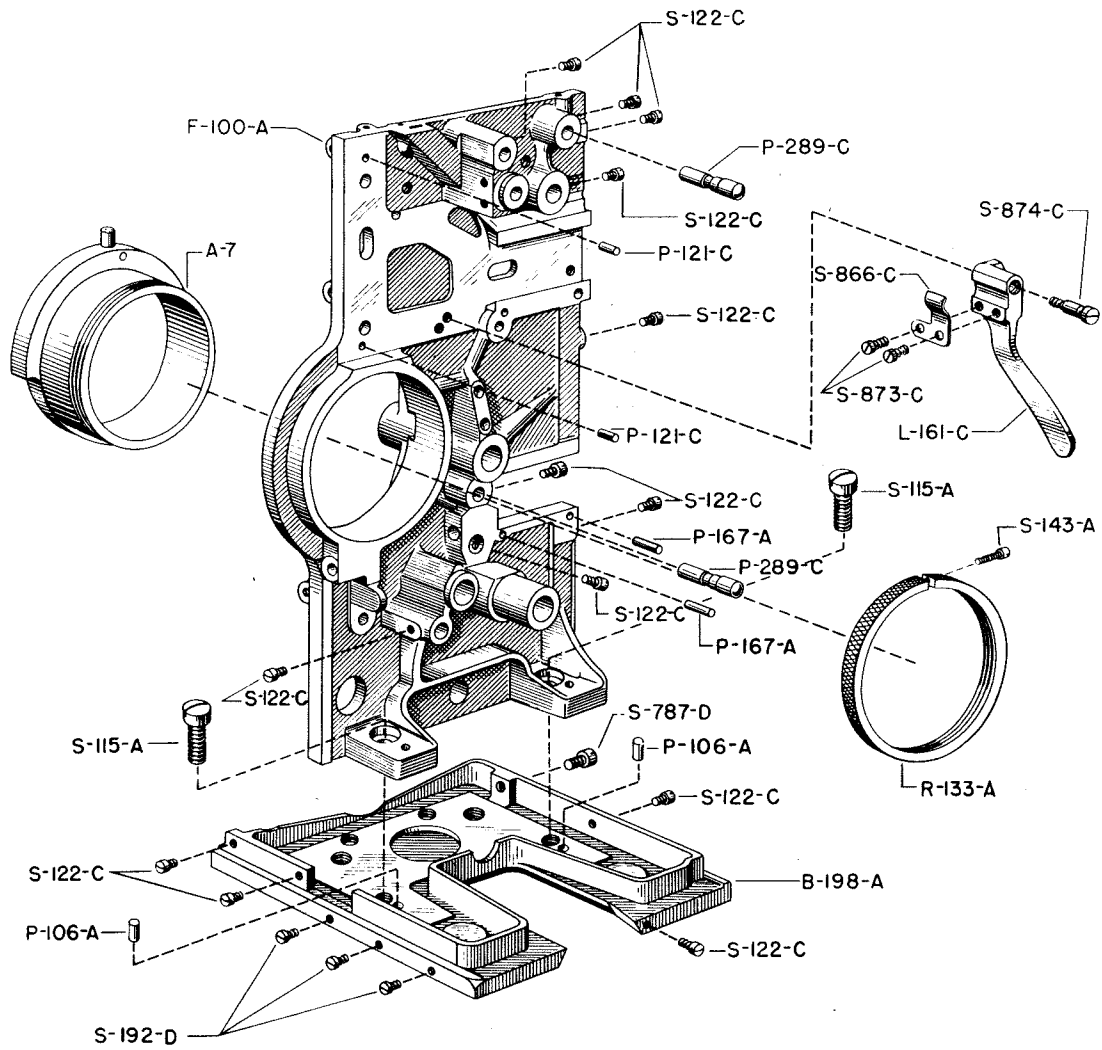

MAIN FRAME — FILM SIDE

MAIN FRAME—FILM SIDE

ASSEMBLIES

C-25 FILM TRAP DOOR TRIP LEVER ASSEMBLY

L-161-C	Film Trap Door Trip Lever
S-866-C	Film Trap Door Trip Lever Spring
S-873-C	Film Trap Door Trip Lever Spring Fastening Screw (2)
S-874-C	Film Trap Door Trip Lever Pivot Screw

PARTS

A-7	Framing Cam, Arm and Pin
B-198-A	Mechanism Base
F-100-A	Mechanism Main Frame
P-106-A	Mechanism Base Dowel Pin (2)
P-121-C	Film Trap Locating Pin (2)
P-167-A	Shutter Adjusting Slide Stop Pin (2)
P-289-C	Upper and Lower Pad Roller Arm Stop Pin (2)
R-133-A	Framing Cam Ring
S-115-A	Main Frame Fastening Screw (2)
S-122-C	Fastening Screw (For C-151-D, C-157-C, C-286-C, P-289-C, P-572-C and S-573-C) (13)
S-143-A	Framing Cam Ring Clamping Screw
S-192-D	Fastening Screw (For D-9) (3)
S-787-D	Fastening Screw (For C-152-D)

OLD STYLE PARTS STILL AVAILABLE (Not illustrated)

S-102-E	Film Trap Door Trip Lever Spring Fastening Screw
S-137-C	Film Trap Door Trip Lever Pivot Screw
S-329-C	Film Trap Door Trip Lever Spring

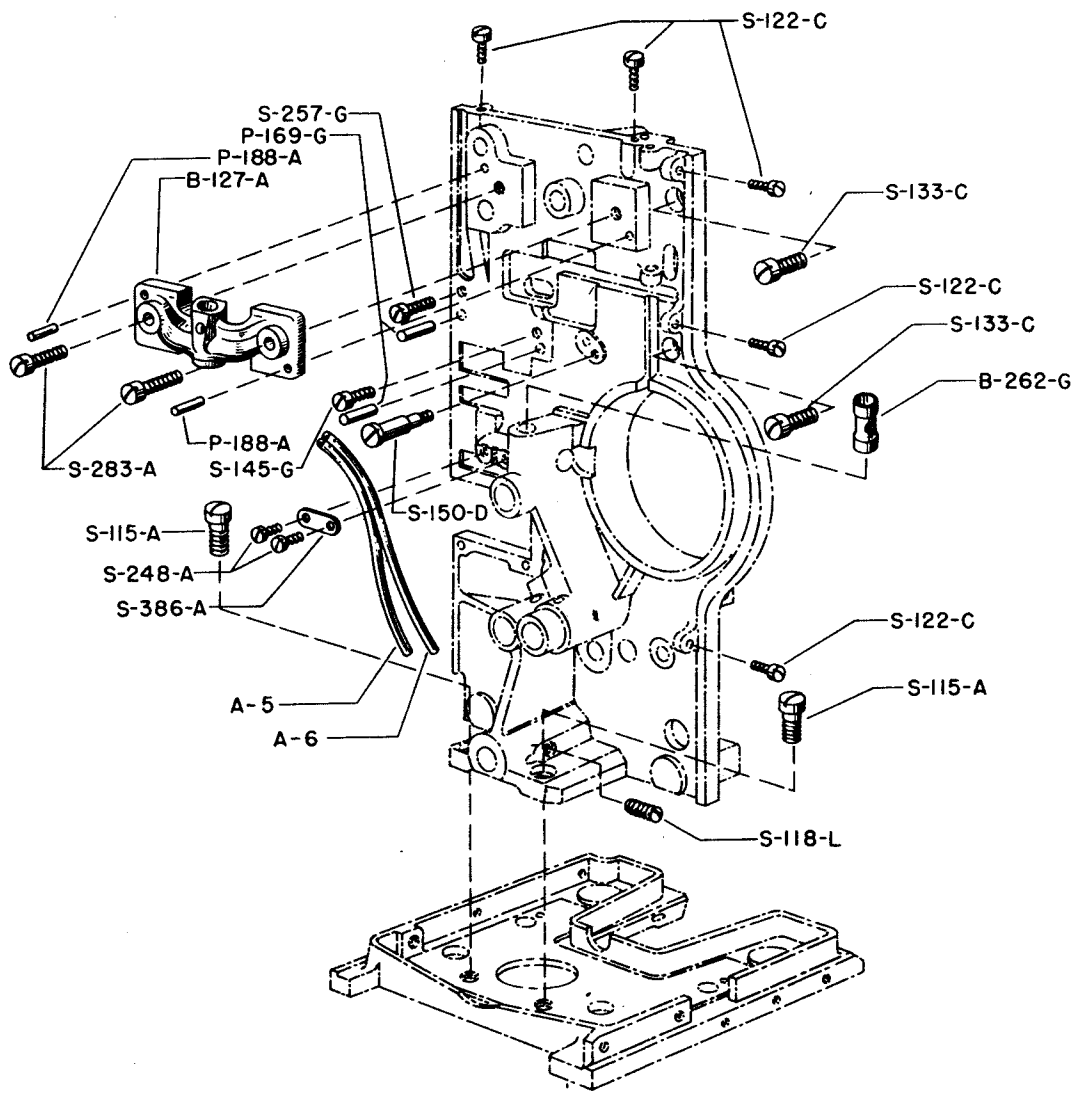

MAIN FRAME — GEAR SIDE

MAIN FRAME—GEAR SIDE

PARTS

A-5	Main Drive Shaft Oil Tube
A-6	Lower Sprocket Shaft Oil Tube
B-127-A	Vertical Shaft Bracket
B-262-G	Vertical Shaft Replacement Bearing
P-167-A	Shutter Adjusting Slide Stop Pin (2)
P-169-G	Shutter Gear Bracket Dowel Pin (2)
P-188-A	Vertical Shaft Bracket Dowel Pin (2)
S-115-A	Main Frame Fastening Screw (2)
S-118-L	Sound Pinion Shaft Fastening Screw
S-122-C	Fastening Screw (For C-151-D and P-207-D) (5)
S-133-C	Film Trap Fastening Screw (2)
S-145-G	Shutter Gear Bracket Fastening Screw (Rear)
S-150-D	Governor Lift Lever Pivot Screw
S-248-A	Oil Tube Clamp Fastening Screw (2)
S-257-G	Shutter Gear Bracket Fastening Screw (Front)
S-283-A	Vertical Shaft Bracket Fastening Screw (2)
S-386-A	Oil Tube Clamp

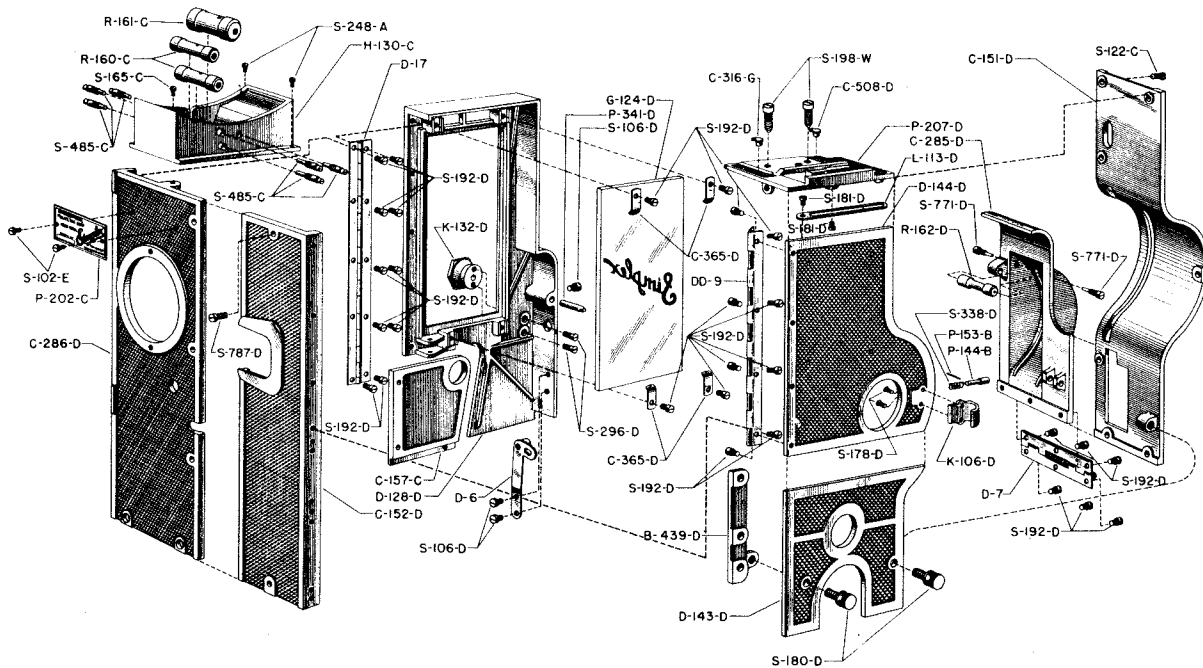

DOORS AND COVERS

ASSEMBLIES

C-8 UPPER MAGAZINE ROLLER HOLDER ASSEMBLY

H-130-C Upper Magazine Roller Holder
 R-160-C Magazine Roller - Small (2)
 R-161-C Magazine Roller - Large
 S-485-C Magazine Roller Pivot Screw (6)

D-5 FILM SIDE DOOR AND KNOB ASSEMBLY

D-17 Film Side Door Hinge
 D-128-D Film Side Door
 K-132-D Film Side Door Knob
 S-192-D Film Side Door Hinge Fastening Screw (5)
 S-246-D Film Side Door Knob Fastening Screw (2)

D-9 REAR DRUM COVER ASSEMBLY (FILM SIDE)

C-285-D Rear Drum Cover
 D-7 Rear Drum Cover Hinge
 R-162-D Rear Drum Cover Stripper Roller
 S-192-D Rear Drum Cover Hinge Screw (3)
 S-771-D Rear Drum Cover Stripper Roller Screw (2)

DOORS AND COVERS (continued)

DD-11 GEAR SIDE UPPER DOOR AND KNOB ASSEMBLY

D-144-D Gear Side Upper Door
DD-9 Gear Side Upper Door Hinge
K-106-D Gear Side Upper Door Knob
S-178-D Gear Side Upper Door Knob Fastening Screw (2)
S-192-D Gear Side Upper Door Hinge Screw (4)

DD-12 GEAR SIDE LOWER DOOR ASSEMBLY

B-439-D Gear Side Lower Door Angle Bracket
D-143-D Gear Side Lower Door
S-180-D Gear Side Lower Door Locking Screw (2)

PARTS

C-151-D Gear Side Rear Cover (For Front Shutter Mechanisms Only)
C-152-D Gear Side Front Cover
C-157-C Film Side Lower Cover
C-286-D Film Side Front Cover
C-316-G Top Plate Oil Cup (Front)
C-365-D Film Side Door Glass Clamp (4)
C-508-D Top Plate Oil Cup (Rear)
D-6 Film Side Door Lock Spring and Button
G-124-D Film Side Door Glass
L-113-D Gear Side Upper Door Stop Link
P-144-B Gear Side Upper Door Lock Pin
P-153-B Gear Side Upper Door Lock Pin Retainer
P-202-C Simplex Name Plate
P-207-D Top Plate
P-341-D Film Side Door Locking Pin
S-102-E Name Plate Fastening Screw (2)
S-106-D Fastening Screw (For D-6 and P-341-D) (3)
S-165-C Upper Magazine Roller Holder Fastening Screw (Front)
S-181-D Gear Side Upper Door Stop Link Screw (2)
S-189-W Upper Magazine Fastening Screw (2)
S-248-A Upper Magazine Roller Holder Fastening Screw (Rear) (2)
S-338-D Gear Side Upper Dock Lock Pin Spring

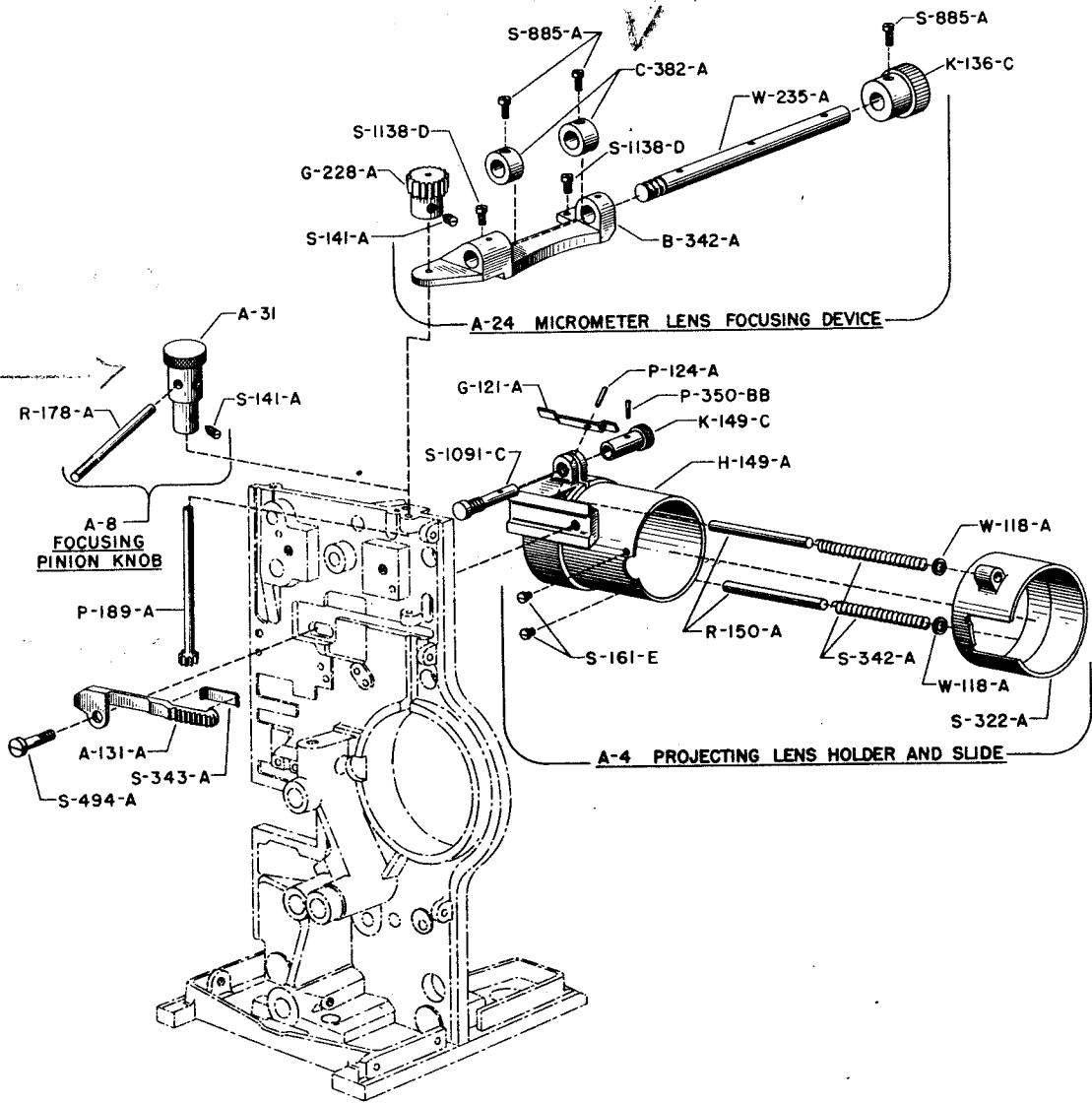

LENS HOLDER AND FOCUSING DEVICES

LENS HOLDER AND FOCUSING DEVICES

A-4 LENS HOLDER AND SLIDE COMPLETE

ASSEMBLIES

C-38 LENS HOLDER CLAMP KNOB AND SCREW

K-149-C

P-350-BB

S-1091-C

PARTS

H-149-A	Lens Holder (Includes C-38, and P-124-A)
K-149-C	Lens Holder Clamp Knob
P-124-A	Focusing Slide Gib Pin
P-350-BB	Lens Holder Clamp Knob Pin
R-150-A	Lens Holder Slide Guide Rod (2)
S-161-E	Lens Holder Slide Stop Screw (2)
S-322-A	Lens Holder Slide
S-342-A	Lens Holder Slide Guide Rod Spring (2)
S-1091-C	Lens Holder Clamp Knob Screw
W-118-A	Lens Holder Slide Guide Rod Washer (2)

A-8 FOCUSING PINION KNOB

PARTS

A-31	Focusing Pinion Knob and Clamp Screw
R-178-A	Focusing Pinion Rod
S-141-A	Focusing Pinion Knob Set Screw

A-24 MICROMETER LENS FOCUSING DEVICE

PARTS

B-342-A	Focusing Device Bracket
C-382-A	Adjusting Knob Collar (2)
G-228-A	Focusing Gear
K-136-C	Adjusting Knob
S-141-A	Focusing Gear Screw
S-885-A	Fastening Screw (For C-382-A and K-136-C) (3)
S-1138-D	Focusing Device Bracket Fastening Screw (2)
W-235-A	Focusing Device Worm

ASSOCIATED PARTS NOT IN ASSEMBLIES

A-131-A	Focusing Rack Arm
G-121-A	Focusing Slide Gib
P-189-A	Focusing Pinion
S-343-A	Rack Arm Friction Spring
S-494-A	Focusing Rack Arm Fastening Screw

DOUBLE SHUTTER ATTACHMENT

DD-67 DOUBLE SHUTTER ATTACHMENT COMPLETE

ASSEMBLIES

- D-95 SHUTTER SPIDER ASSEMBLY (Included in DD-65)
S-1026-D (2)
- DD-62 REAR SHUTTER BLADE ASSEMBLY
B-332-D N-267-D (2) W-231-D (12)
B-437-D S-132-E (6)
B-465-D S-1549-D (2)
- DD-64 FRONT SHUTTER MOUNTING COVER ASSEMBLY
C-485-D S-1399-D (4)
- DD-65 FRONT SHUTTER BLADE AND SPIDER ASSEMBLY
B-437-D D-92 S-192-D (5)
B-438-D N-267-D (2) S-1549-D (2)
- DD-68 SHUTTER SHAFT AND GEAR ASSEMBLY
G-203-G P-107-G S-1455-D
- DD-72 ACCESSORY KIT
H-250-D R-301-R S-1404-R
I-114-R
- E-75 AIR DEFLECTOR AND APERTURE COOLING UNIT
C-479-E (3) P-663-E S-1541-E (4)
DD-58 R-303-E S-1550-E (4)
G-292-E S-132-E (3) S-1553-E (3)
H-246-E S-1430-E (2)

PARTS

- B-332-E Shutter Fan Blade (2)
B-437-D Shutter Adjusting Blade (2)
B-438-D Front Shutter Main Blade
B-440-D Front Shutter Guard Bracket (6)
B-465-D Rear Shutter Main Blade
C-479-E Glass Retaining Clip (3)
C-485-D Front Shutter Mounting Cover
D-168-W Decal - Patent Notice
DD-58 Rear Shutter Guard Light Cap
DD-86 Front Shutter Guard (Front Section)
G-203-G Double Shutter Shaft Gear
G-292-E Fire Shield Hood Glass
G-320-D Front Shutter Guard (Rear Section)
H-246-E Fire Shield Hood Glass Holder
H-250-D Shutter Aligning Rod Holder
I-114-R Movement Indicator
N-245-D Front Shutter Guard Stud Nut (4)
N-267-D Nut (For S-1549-D) (4)

DOUBLE SHUTTER ATTACHMENT (Continued)

P-107-G	Double Shutter Shaft Gear Pin
P-562-D	Shutter Guard Holding Support Plate (6)
P-660-D	Front Shutter Guard Strap Plate (2)
P-663-E	Fire Shield Hood Plate
R-299-D	Front Shutter Guard Support Rod (3)
R-301-R	Shutter Alignment Rod
R-303-E	Glass Holder Retainer
S-132-E	Fastening Screw (For B-332-D and C-479-E) (9)
S-192-D	Shutter Spider Fastening Screw (5)
S-882-A	Fastening Screw (For B-440-D and S-1400-D) (15)
S-989-G	Shutter Guard Retaining Screw (6)
S-1026-D	Shutter Spider Clamp Screw (2)
S-1399-D	Front Shutter Guard Stud (4)
S-1400-D	Front Shutter Guard Support
S-1404-R	Aligning Rod Holding Screw
S-1422-D	Front Shutter Guard Strap
S-1430-E	Slide Pressure Spring (2)
S-1441-D	Front Shutter Guard Strap Screw (2)
S-1455-D	Double Shutter Shaft
S-1541-E	Slide Pressure Spring Screw (4)
S-1549-D	Adjusting Blade Fastening Screw (4)
S-1550-E	Fire Shield Hood Plate Screw (4)
S-1553-E	Glass Holder Retaining Screw (3)
W-231-D	Washer (For S-132-E Screw - Two under each screw) (12)
W-298-D	Front Shutter Guard Stud Washer (2)

ACCESSORIES

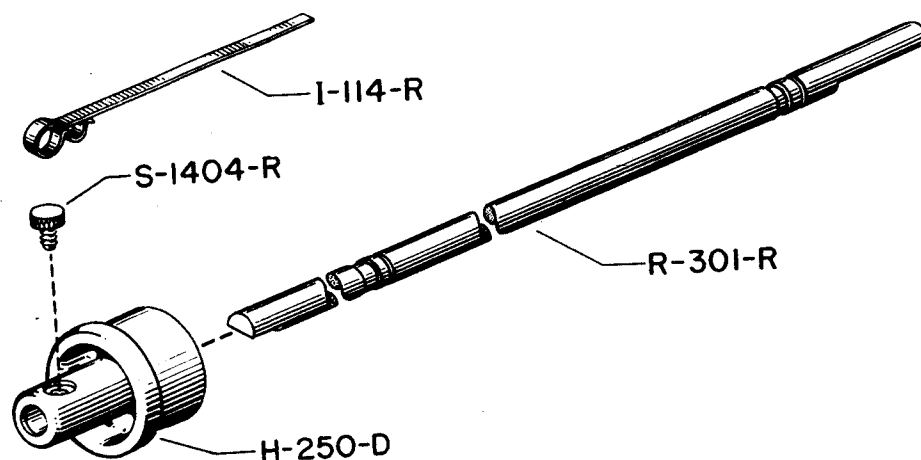

Manufacture of the Simplex Single Bearing Intermittent Movement was discontinued in 1933. Complete and partial factory repairs to this unit were discontinued in 1939.

This move was made in the interest of better projection. The use of Simplex Double Bearing Intermittent Movements in theatres for years has proven beyond doubt their performance superiority. Hardened and ground parts, closer accuracy in manufacture and longer wearing qualities are but a few of the many advantages that all result in better projection and a steadier picture.

The Simplex Double Bearing Intermittent Movement is illustrated on pages 8, 9 and 10. It directly replaces the Simplex Single Bearing Intermittent Movement without additional parts or alterations in any Simplex Regular Mechanism.

MAKE A BETTER PROJECTION CHANGE NOW.



LIKE ALL fine precision machines, SIMPLEX projectors require proper periodic lubrication to continue functioning at peak efficiency.

To assure that this lubrication is exactly suited to the job it has to do, SIMPLEX engineers have had SIMPLEX OIL and SIMPLEX REAR SHUTTER GREASE especially compounded for use in SIMPLEX mechanisms.

For your protection, ask for genuine SIMPLEX OIL and SIMPLEX REAR SHUTTER GREASE—the perfect SIMPLEX lubricants, in the yellow and black containers!

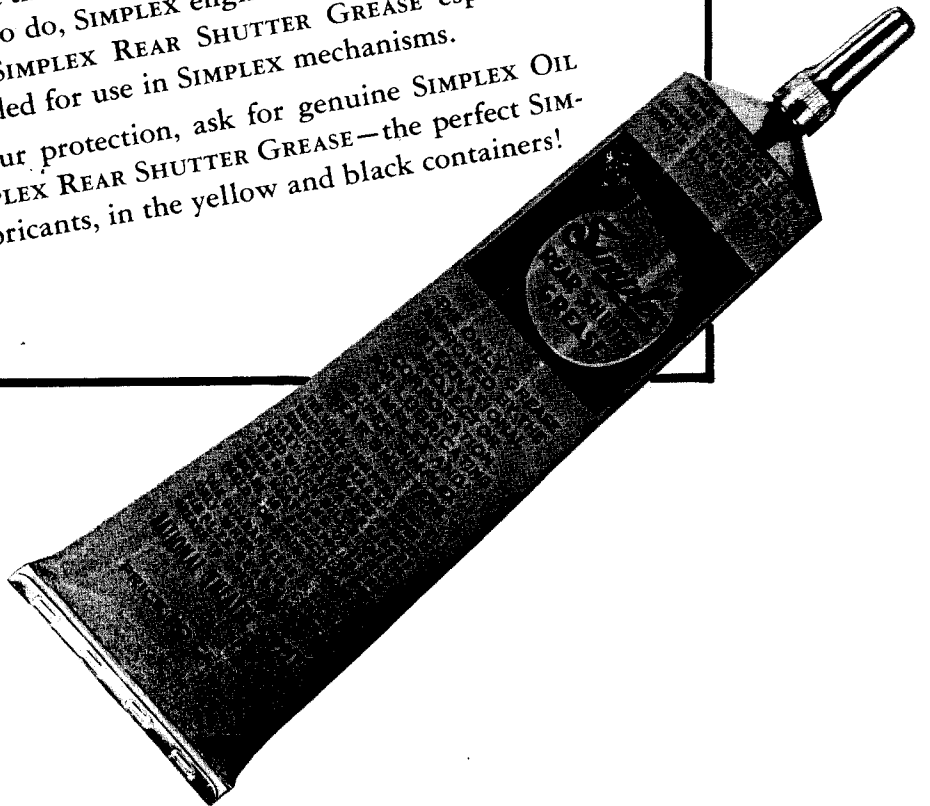

SIMPLEX REGULAR PARTS PRICE LIST

<u>PART NUMBER</u>	<u>PRICE</u>	<u>PART NUMBER</u>	<u>PRICE</u>	<u>PART NUMBER</u>	<u>PRICE</u>
A-2	1.55	BB-30	3.60	C-503	.90
A-4	5.45	BB-31	.10	C-507	.10
A-5	.40	BB-38	7.00	C-508	.15
A-6	.40	BB-40	9.80	C-509	.25
A-7	5.50	BB-42	6.50		
A-8	1.35	BB-52	12.95	D-3	1.40
A-24	5.60	BB-56	.95	D-5	4.60
A-30	6.80	BB-57	.50	D-6	.50
OS.001	7.70	BB-58	12.90	D-7	.60
.002	7.70			D-9	3.50
.003	7.70	C-2½	2.20	D-17	.55
.004	7.70	C-3½	3.00	D-74	8.15
.005	7.70	C-8	5.75	D-75	3.90
A-31	1.05	C-16	.60	D-80	2.85
		C-21	4.20	D-86	6.80
A-131	.80	C-25	2.15	D-89	2.90
A-136	1.80	C-38	.95	D-91	4.10
A-192	8.05	C-59	2.65	D-92	1.85
A-215	1.45			D-93	5.70
		C-127	.10	D-94	2.50
B-106	.15	C-151	2.90	D-95	1.40
B-127	2.20	C-152	2.05		
B-198	6.60	C-157	1.40	D-128	2.65
		C-193	.40	D-130	.35
B-246	2.55			D-143	2.40
B-262	1.15	C-285	1.70	D-144	2.80
B-297	2.65	C-286	2.25	D-145	2.50
		C-294	.10	D-148	2.60
B-314	6.15	C-295	.40	D-168	.10
B-316	.10				
B-323	1.70	C-316	.10	DD-4	4.05
B-325	9.25	C-344	.25	DD-7	12.00
B-332	.20	C-346	.50	DD-8	10.20
B-341	.60	C-365	.10	DD-9	.55
B-342	1.70	C-366	.15	DD-11	4.40
		C-371	2.60	DD-12	3.25
B-437	1.15	C-375	11.35	DD-23	.95
B-438	1.15	C-378	.60	DD-58	1.35
B-439	.75	C-382	.35	DD-62	4.00
B-440	.35			DD-64	4.60
B-465	1.00	C-400	.10	DD-65	5.85
B-466	2.05	C-406	.10	DD-68	4.50
B-481	2.55	C-407	.10	DD-72	5.05
B-482	1.30	C-463	.60	DD-73	5.50
B-484	3.40	C-467	.15	DD-85	2.65
B-485	.95	C-479	.10	DD-86	2.20
B-486	.10	C-483	.50		
B-500	.10	C-485	4.05	E-2	5.70
		C-495	.15	E-3	2.05
BB-27	2.60	C-498	.10	E-6	1.15
BB-28	5.05			E-14	2.75

SIMPLEX REGULAR PARTS PRICE LIST

<u>PART NUMBER</u>	<u>PRICE</u>	<u>PART NUMBER</u>	<u>PRICE</u>	<u>PART NUMBER</u>	<u>PRICE</u>
E-19	6.60	G-186	1.00	K-141	.35
E-40	4.05	G-187	1.15	K-149	.40
E-43	2.40	G-188	.10	K-150	.25
E-45	4.10				
E-46	14.55	G-203	.90	L-104	1.15
E-49	10.50	G-206	1.45	L-105	1.15
E-75	7.30	G-211	.10	L-110	.10
E-81	12.45	G-220	.40	L-111	.50
E-82	1.20	G-222	3.90	L-112	.10
E-86	1.25	G-224	2.15	L-113	.35
E-92	21.05	G-225	.10	L-130	.60
		G-226	.10	L-161	2.00
F-100	79.20	G-228	.90	L-162	.40
F-172	6.75	G-243	1.70	L-177	1.35
F-174	2.15	G-248	2.35	L-185	.15
		G-278	2.35	L-186	.20
G-3	1.85	G-279	5.75	L-206	.25
G-4	3.70	G-282	2.35		
G-5	4.20	G-283	1.45	N-123	.35
G-6	23.25	G-292	1.20	N-166	.10
G-12	2.90			N-172	.35
G-13	5.25	G-307	3.25	N-197	.10
G-15	6.60	G-308	5.30		
G-28	.80	G-317	.10	N-201	.20
G-35	3.25	G-320	2.00	N-202	1.00
OS.001	4.10	G-322	2.65	N-204	.20
.002	4.10			N-212	.10
.003	4.10	GG-5	13.70	N-245	.10
.004	4.10	GG-6	12.55	N-258	.10
.005	4.10	GG-9	11.90	N-259	.10
G-40	19.80	GG-10	10.90	N-260	.10
G-64	9.35			N-261	.15
G-73	5.30	H-120	1.40	N-263	.40
G-77	21.15	H-121	1.35	N-267	.10
G-79	22.00	H-130	2.80		
G-87	7.80	H-149	4.75	P-100	1.00
G-92	6.60			P-102	1.15
		H-214	2.55	P-106	.10
G-111	1.20	H-246	1.10	P-107	.10
G-115	2.50	H-250	2.90	P-121	.10
G-116	1.35	H-251	1.45	P-124	.10
G-121	.15			P-127	.10
G-124	.80	I-114	.15	P-128	.10
G-125	.20			P-144	.20
G-126	.25	K-106	.80	P-153	.10
G-134	1.20	K-120	1.15	P-167	.10
G-135	4.75	K-130	.40	P-169	.10
G-138	1.35	K-132	.50	P-188	.10
G-139	2.50	K-136	.20	P-189	1.75
G-181	1.60	K-137	.35		
G-185	2.00	K-139	.20	P-202	.15

SIMPLEX REGULAR PARTS PRICE LIST

<u>PART NUMBER</u>	<u>PRICE</u>	<u>PART NUMBER</u>	<u>PRICE</u>	<u>PART NUMBER</u>	<u>PRICE</u>
P-207	2.00	R-214	1.10	S-322	.75
P-289	.10	R-245	.90	S-323	1.70
		R-255	.70	S-326	.10
P-325	.55	R-261	2.20	S-327	.10
P-334	.95	R-264	1.20	S-328	.10
P-341	.10	R-274	.40	S-329	.10
P-350	.10	R-299	.70	S-330	.10
P-353	.10			S-338	.10
P-359	.10	R-301	2.00	S-340	.10
P-360	.35	R-303	1.40	S-342	.10
P-368	.10	R-311	.10	S-343	.10
P-372	1.20	R-312	.10	S-353	.10
P-379	1.60			S-357	.25
P-380	.15	S-100	.10	S-367	.75
P-445	.35	S-101	.10	S-369	1.15
P-462	.60	S-102	.10	S-386	.10
P-466	.10	S-106	.10		
P-468	.20	S-115	.10	S-432	.10
		S-118	.10	S-434	.10
P-527	1.15	S-122	.10	S-436	.10
P-528	1.15	S-125	.10	S-437	.10
P-529	.35	S-130	.10	S-442	.10
P-530	.35	S-132	.10	S-485	.10
P-541	.20	S-133	.10	S-493	.10
P-543	1.20	S-137	.20	S-494	.15
P-544	.20	S-141	.10		
P-545	.10	S-143	.10	S-514	.25
P-552	1.70	S-145	.10	S-550	1.35
P-554	.20	S-150	.10	S-567	.55
P-562	.10	S-151	.10	S-569	.10
		S-161	.10	S-570	.10
P-660	.15	S-165	.10	S-572	.70
P-663	1.30	S-177	.10	S-573	.50
P-671	.60	S-178	.10	S-580	.25
P-672	.50	S-180	.20	S-581	.10
P-687	.10	S-181	.10		
P-688	.10	S-189	.20	S-665	.25
		S-192	.10	S-705	.10
P-709	.80	S-193	.35	S-706	.20
P-713	.10			S-724	.10
P-719	.10	S-223	.10	S-725	.10
P-723	.70	S-246	.10	S-726	1.30
		S-248	.10	S-728	.10
R-120	.15	S-252	.35	S-729	.10
R-128	.10	S-253	.15	S-731	.40
R-133	3.05	S-257	.10	S-736	.50
R-150	.10	S-278	.10	S-762	.10
R-160	.80	S-283	.10	S-765	.10
R-161	.80			S-771	.10
R-162	.35	S-309	1.20	S-777	.10
R-178	.40	S-321	3.40	S-778	.10

SIMPLEX REGULAR PARTS PRICE LIST

<u>PART NUMBER</u>	<u>PRICE</u>	<u>PART NUMBER</u>	<u>PRICE</u>	<u>PART NUMBER</u>	<u>PRICE</u>
S-781	1.55	S-1135	.75	S-1542	.15
S-787	.10	S-1136	.10	S-1549	.10
S-871	1.85	S-1137	.10	S-1550	.15
S-873	.10	S-1138	.10	S-1553	.10
S-874	.20	S-1139	.10	S-1554	.10
S-882	.15	S-1140	.10	T-101	.20
S-884	.10	S-1141	.10	T-137	.60
S-885	.10	S-1143	1.30	T-168	.25
S-897	.15	S-1144	.10	T-169	.20
S-898	.10	S-1145	.10	T-170	.20
S-902	.10	S-1147	.10	T-172	13.20
S-905	.10	S-1148	.10	W-112	.10
S-932	.10	S-1149	.10	W-114	.10
S-951	10.00	S-1157	.10	W-118	.10
S-962	.10	S-1159	.10	W-140	.25
S-966	.20	S-1160	1.20	W-145	2.00
S-973	.10	S-1234	.10	W-146	2.00
S-987	.10	S-1361	.35	W-148	.25
S-989	.10	S-1372	.10	W-160	.10
S-997	.35	S-1391	.20	W-191	2.75
S-999	.35	S-1392	1.70	W-198	.10
S-1004	.10	S-1399	.15	W-227	.10
S-1005	.10	S-1400	3.50	W-231	.10
S-1011	.10	S-1401	.75	W-235	1.80
S-1026	.10	S-1404	.20	W-298	.10
S-1031	2.00	S-1422	.15	W-306	.35
OS.001	2.85	S-1430	.10	W-319	.10
.002	2.85	S-1432	.10	W-321	.25
.003	2.85	S-1441	.10	W-326	.10
.004	2.85	S-1447	.10	W-328	.50
.005	2.85	S-1452	.50	W-330	.10
S-1033	1.30	S-1455	3.00	W-332	.10
OS.0015	2.15	S-1479	.10	W-334	.40
.0025	2.15	S-1481	.10	W-335	.10
.0035	2.15	S-1482	.10	W-339	.10
.0045	2.15	S-1483	.10		
.0055	2.15	S-1484	.10		
S-1039	.10	S-1485	.10		
S-1045	1.35	S-1502	.35		
S-1046	1.75	S-1503	.50		
S-1069	.10	S-1504	.10		
S-1082	2.55	S-1505	.10		
S-1091	.15	S-1507	.10		
S-1092	.60	S-1511	.10		
S-1093	.75	S-1515	.10		
S-1129	.10	S-1527	.10		
S-1134	.75	S-1535	.10		
		S-1541	.10		