

FILM-TECH

THE INFORMATION CONTAINED IN THIS ADOBE ACROBAT PDF FILE IS PROVIDED AT YOUR OWN RISK AND GOOD JUDGMENT.

THESE MANUALS ARE DESIGNED TO FACILITATE THE EXCHANGE OF INFORMATION RELATED TO CINEMA PROJECTION AND FILM HANDLING, WITH NO WARRANTIES NOR OBLIGATIONS FROM THE AUTHORS, FOR QUALIFIED FIELD SERVICE ENGINEERS.

IF YOU ARE NOT A QUALIFIED TECHNICIAN, PLEASE MAKE NO ADJUSTMENTS TO ANYTHING YOU MAY READ ABOUT IN THESE ADOBE MANUAL DOWNLOADS.

WWW.FILM-TECH.COM

SUPPLY PARTS
AND
DIRECTIONS FOR OPERATION AND MAINTENANCE
of
GRISWOLD FILM SPLICER

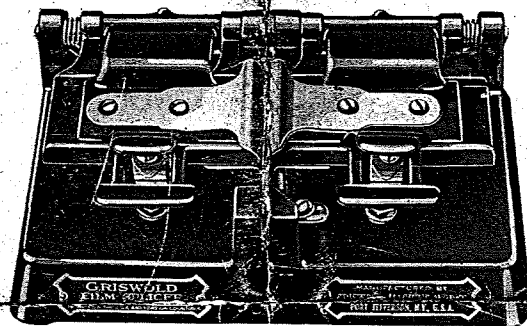

Model R2 for 35 mm. Film

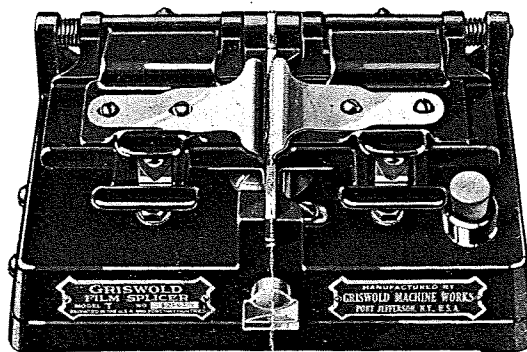

Model T for 35 mm. Film

Manufactured by
GRISWOLD MACHINE WORKS
PORT JEFFERSON, N. Y.
U. S. A.

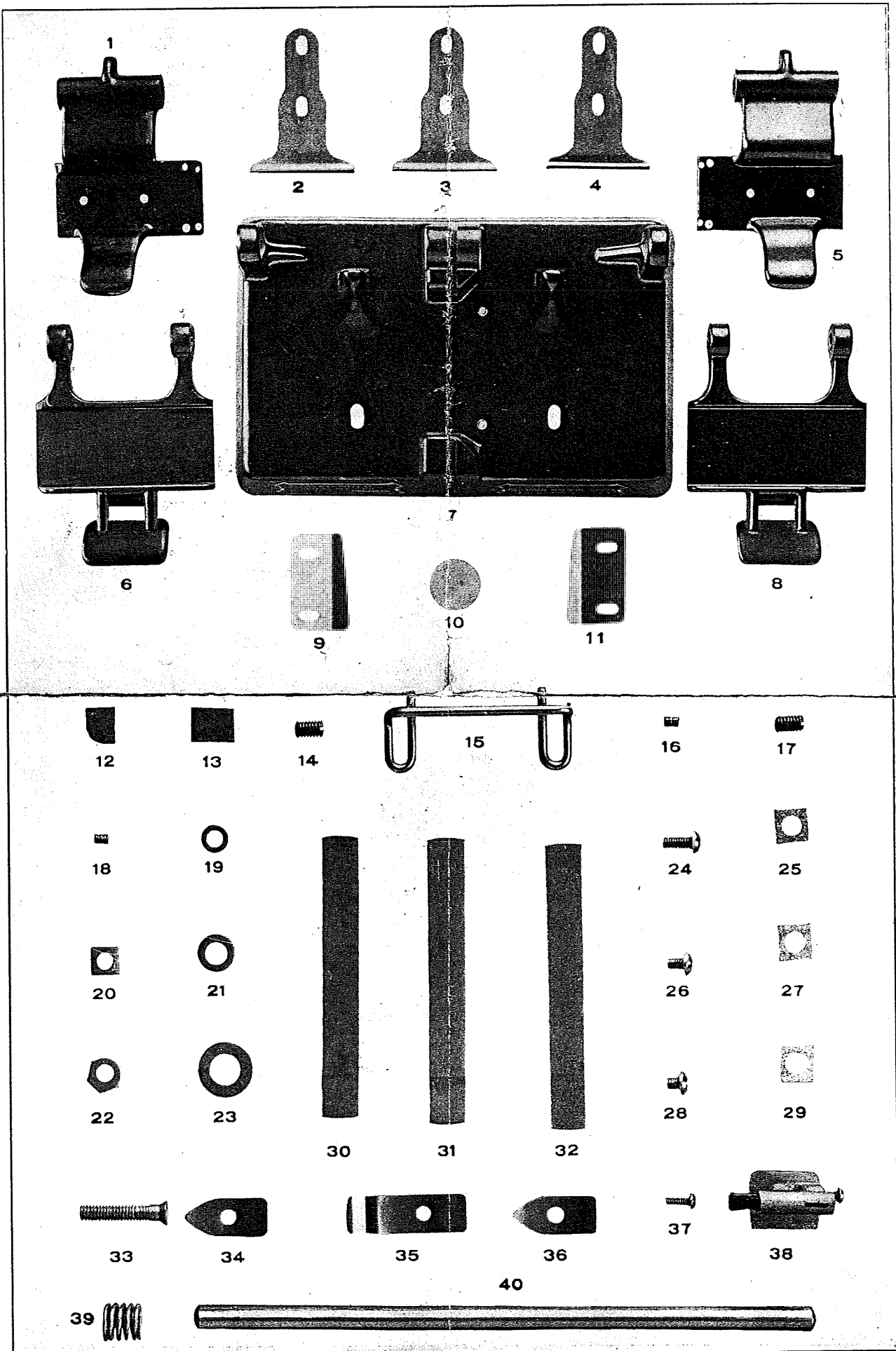

SUPPLY PARTS FOR MODEL R2 AND MODEL T GRISWOLD FILM SPLICERS

SUPPLY PARTS FOR MODEL R2 AND MODEL T GRISWOLD FILM SPLICERS

Orders should state model, width of splice and serial number.

No.	NAME	PRICE
1	Upper Left Jaw.....	2.25
2	Cement Guard (Attaches to Upper Left Jaw).....	.45
3	Lower Pressure Spring (Attaches to Upper Right Jaw).....	.45
4	Upper Pressure Spring (Attaches to Upper Right Jaw).....	.45
5	Upper Right Jaw.....	2.25
6	Lower Left Jaw.....	3.00
7	Base.....	6.00
8	Lower Right Jaw.....	3.00
9	Upper Left Shear Blade.....	.45
10	Felt Moistener.....	.05
11	Upper Right Shear Blade.....	.45
12	Back Adapter (Used on 1/16" Lower Shear Blade).....	.10
13	Front Adapter (Used on 1/16" Lower Shear Blade).....	.10
14	Hinge Rod Set Screw.....	.05
15	Emulsion Scraper Guide.....	.40
16	Lower Shear Blade Adjusting Screw.....	.05
17	Lower Shear Blade Set Screw.....	.05
18	Pressure Spring Adjusting Screw.....	.05
19	Washer for Emulsion Scraper Guide.....	.05
20	Lower Nut for Latch Pin.....	.05
21	Washer for Latch Pin.....	.05
22	Upper Nut for Latch Pin.....	.05
23	Hinge Rod Binder Collar.....	.20
24	Screw for Emulsion Scraper Guide.....	.05
25	Emulsion Scraper Blade 1/16" Splice.....	.12
26	Upper Shear Blade or Latch Spring Screw.....	.05
27	Emulsion Scraper Blade 1/10" Splice.....	.12
28	Screw for Guard or Pressure Spring.....	.05
29	Emulsion Scraper Blade 5/32" Splice.....	.12
30	Lower Shear Blade for 1/16" Splice.....	1.00
31	Lower Shear Blade for 1/10" Splice.....	1.00
32	Lower Shear Blade for 5/32" Splice.....	1.00
33	Latch Pin.....	.15
34	Outer Supplementary Latch Spring.....	.10
35	Latch Spring.....	.15
36	Inner Supplementary Latch Spring.....	.10
37	Scraper Blade Screw.....	.05
38	Scraper Holder.....	.75
39	Thrust Spring.....	.12
40	Hinge Rod.....	1.00
	Part 34-35-36 Latch Spring Assembly.....	.25

Screws, Nuts and Washers listed @ 5c. each, will be sold at 45c. per dozen in lots of one kind.

IMPORTANT SUGGESTIONS

Follow the instructions on next page carefully. By so doing you will do quicker and better quality of work.

The manner of using the emulsion scraper is important. Before inserting the blade in scraper holder see that the blade and slot for receiving blade are perfectly clean so that the blade will go back against stop, as any foreign substance will cause the blade to protrude, thereby causing the blade to remove too much emulsion, which will leave a transparent line beyond the splice. The emulsion scraper blade should be held firmly against the stop when adjusting the screw which holds it.

There are eight positions in which to place the emulsion scraper blade in the holder, each position presenting a new scraping edge.

Usually a very thin film cement does not work as well as a cement having a little body. If trouble is experienced in making splices hold, try thickening the cement by dissolving a small quantity of celluloid film in the cement to bring it up to the best working consistency.

Do not attempt to change any adjustments on a new splicer. We guarantee each splicer to be in proper operative condition when shipped.

The cement guard attached to upper left jaw should not protrude below the lower face of the jaw and should be spaced fully a 1/64" from the left edge of lower shear blade. This guard is to prevent applying cement where not needed.

GRISWOLD FILM SPLICER

MODEL R2 AND MODEL T 35 mm.

CYCLES OF OPERATIONS

Swing upper jaw of right clamp up against stop. Swing left film clamp (comprising upper and lower jaws) back against stop.

Place film emulsion side up on lower right jaw with dividing line over center of lower shear blade, bring upper jaw down on film.

Bring down left film clamp cutting film, raise right film clamp with film.

Swing upper jaw of left film clamp back against stop. Place other section of film, emulsion side up, on lower left jaw, with dividing line over center of lower shear blade, bring upper left jaw down on film.

Bring down right clamp to cut film and swing it back again to stop.

With dampened felt disc moisten emulsion on film held by left film clamp overlapping lower shear blade. This is not absolutely necessary but is especially advisable on old film.

WITH THE BRUSH END OF SCRAPER DOWNWARD, insert lip between guide and lower shear blade, incline scraper direction of travel, scrape emulsion from center of film off edge each way (the brush on scraper is for use in removing any particles of emulsion which may remain on the film after scraping).

With the left hand raise the left clamp with film so that film is about $\frac{1}{4}$ " above lower shear blade. While film is being held in this position, apply cement with one stroke of brush, then bring left clamp down on stop and immediately bring right film clamp carrying other section of film down on stop.

After allowing a few seconds for the initial set of cement, raise upper jaws of right and left film clamps and wipe off surplus cement with dry cloth.

The film is now spliced and may be removed and wound in the reel.

Do not allow this machine to become rusty or allow cement to accumulate upon the steel parts; cement is easily removed by painting with film cement and wiping off with dry cloth.

— G U A R A N T E E —

The Griswold Film Splicer is guaranteed against imperfections in material and workmanship; the manufacturer agrees to replace free of charge any part which may, within one year from date of purchase, prove to be defective, ordinary wear and tear excepted, the defective part to be returned to our works at Port Jefferson, N. Y., with serial number of machine and transportation charges prepaid.

This guarantee does not cover the replacement of parts damaged by accident, abuse or violence.

THE GRISWOLD FILM SPLICER is licensed under the following patents:

October 26, 1920

April 18, 1922

August 7, 1923 (Two)

August 24, 1926

MANUFACTURED BY

GRISWOLD MACHINE WORKS

PORT JEFFERSON, N. Y.

U.S.A.